

## Hand Pallet Trucks

Record BF2000 / BF2500 / BF3000  
Pallet Truck

✓ A budget priced, heavy duty pallet truck with no compromise on quality

- Capacity 2000kg, 2500kg or 3000kg
- Fork widths 455, 540 & 685mm
- Fork lengths 1000 & 1150mm
- Rubber tyred, aluminium steer wheels
- Tandem nylon load rollers
- Extremely robust chassis and pump unit
- Many other specialist sizes available from stock
- 2500kg and 3000kg capacity trucks available from stock
- 57 mm Low profile trucks available from stock

FORKS W x L (mm)	2000kg CAPACITY		2500kg CAPACITY		3000kg CAPACITY	
	ORDER REF	PRICE	ORDER REF	PRICE	ORDER REF	PRICE
540 x 1000	BF205401000	£169.00	BF255401000	£174.00	-	-
540 x 1150	BF205401150	£169.00	BF255401150	£174.00	BF305401150	£247.00
685 x 1000	BF206851000	£169.00	BF256851000	£174.00	-	-
685 x 1150	BF206851150	£169.00	BF256851150	£174.00	BF306851150	£247.00
455 x 1000	BF204551000	£202.00	< Specially for the print trade A2 size pallets			

Many other sizes, capacities & wheel options available from stock... Just Ask

Kentruck SH2000 / SH2500  
Pallet Truck

✓ A premium quality, European built pallet truck with many unique design features and top build quality

- Capacity 2000kg and 2500kg
- Fork widths 460, 520 & 685mm
- Fork lengths 915, 1015 & 1220mm
- Innovative "Swan" neck design gives a turning circle of 300° and allows long loads to be easily transported
- Nylon wheels, single nylon load rollers
- Lighter than a conventional pallet truck
- Special lengths and widths made quickly to order. Just call us!

FORKS W x L (mm)	2000kg CAPACITY		2500kg CAPACITY	
	ORDER REF	PRICE	ORDER REF	PRICE
460 x 915	SH20460915N	£322.00	SH25460915N	£338.00
460 x 1015	SH204601015	£322.00	SH254601015	£338.00
520 x 915	SH20520915N	£293.00	SH25520915N	£309.00
520 x 1015	SH205201015	£293.00	SH255201015	£309.00
520 x 1220	SH205201220	£293.00	SH255201220	£309.00
685 x 915	SH20685915NNS	£319.00	SH25685915NNS	£332.00
685 x 1015	SH206851015	£319.00	SH256851015	£332.00
685 x 1220	SH206851220	£319.00	SH256851220	£332.00

Many other sizes, capacities & wheel options available from stock... Just Ask

## Record Weighing Pallet Trucks

✓ A quality hand pallet truck with a built in pallet weighing system. The weighing system is powered by rechargeable batteries so it can be used anywhere

- Capacity 2000kg
- Fork widths 545 & 690mm
- Fork lengths 1150mm
- Weigh Scale Accuracy  $\pm 0.1\%$
- Rechargeable batteries give around 40 hours use of weighing system from a charge. The truck is supplied complete with battery charger and mains lead
- Weight can be shown in either kg or lbs

FORKS W x L (mm)	CAPACITY (kg)	ORDER REF	PRICE
545 x 1150	2000	WS1150/540	£974.00
690 x 1150	2000	WS1150/690	£1099.00



The robust pump unit features protection around the main spring. Rubber wheels provide a smoother ride.

★ **BEST** ★  
**BUY**

**FROM**  
**£169**



The swan neck design gives a turning circle of 300° and allows long loads to be easily transported

**FROM**  
**£293**



**CE**  
**MARKED**

**RAPID**  
**DELIVERY**

**FROM**  
**£974**

**SPARTAN****Economy Hand Pallet Trucks**

✓ A highly practical budget pallet truck for everyday use – designed for Euro and standard size UK pallets

✓ Capacity 2500kg

- 4 standard fork configurations
- 3 position control, lift – lower – neutral
  - Durable construction
- Polyurethane wheels, single rollers

**Economy Hand Pallet Trucks**

FORK WIDTH (mm)	FORK LENGTH (mm)	ORDER REF	PRICE
550	1000	EC02000/5210	£197.00
550	1150	EC02000/5211	£197.00
685	1000	EC02000/6810	£197.00
685	1150	EC02000/6811	£197.00



**RAPID  
DELIVERY**

★ **NEW** ★  
**PRODUCTS**

**ROBUR Hand Pallet Trucks**

✓ High quality, heavy duty pallet trucks

✓ High strength - low weight ratio ensure maximum manoeuvrability

✓ Capacity 2500kg

- Fork width: 480 x fork length 900mm
- Fork width: 550 x fork lengths 900, 1150mm
- Fork width: 685 x fork length 1150mm
- 3 position control, lift – lower – neutral
- Rubbed polyurethane wheels, single rollers standard
  - Durable high tensile steel construction
  - Quick lift on all models



ALL FORK SIZES  
**£398**

Galvanised Models  
All fork sizes.

REF HPTG2000  
PRICE £398.00

Stainless Steel Models  
Not illustrated. All fork sizes.

REF HPTSS2000 PRICE £1229.00

**2500kg Hand Pallet Trucks • Regular fork options**

FORK WIDTH (mm)	FORK LENGTH (mm)	ORDER REF	PRICE
480	900	HPTQ2000/4609	£263.00
550	900	HPTQ2000/5409	£263.00
540	1150	HPTQ2000/5411	£263.00
685	1150	HPTQ2000/6811	£263.00

**2500kg Hand Pallet Trucks • Special fork options**

OPTION	ORDER REF	STANDARD PRICE
540 x 1500mm FORKS	1500L	£404.00
540 x 2000mm FORKS	2000L	£470.00
540 x 2500mm FORKS	2500L	£570.00
57mm LOW PROFILE	57/LP	£291.00



## Hand Pallet Trucks



LLT500  
£159



## Mini Hand Pallet Truck

- ✓ 500kg capacity, weight only 35kg
- ✓ Light and compact design makes it an ideal companion for van or small lorry drivers

- Designed for light to medium use
- Highly manoeuvrable, turning radius 700-800mm
- Width over forks 380mm, length 800mm
- Polyurethane steer wheel and single nylon load wheels
- Lift height 60-170mm

FORK LENGTH (mm)	WIDTH OVER FORKS (mm)	ORDER REF	PRICE
800	380	LLT500	£159.00



ALL FORK SIZES  
£295



FORK WIDTH  
ADJUSTMENT

## Adjustable Hand Pallet Truck

- ✓ 2500kg capacity
- ✓ Highly versatile, can be adjusted to suit different pallet sizes

- Heavy duty, robust design
- Width over forks 400-520mm, and 530-680mm
- Fork lengths 910, 1060, 1160mm
- Raised height of forks 196mm
- Lowered height 76mm for easy pallet entry
- Hard wearing, easy rolling polyurethane wheels
- High quality hydraulic pump with controlled lowering
- Ergonomic comfortable steer handle

FORK LENGTH (mm)	WIDTH OVER FORKS (mm)	ORDER REF	PRICE
910	400-520	PTA25MS	£295.00
1060	400-520	PTA25M	£295.00
1160	400-520	PTA25ML	£295.00
910	530-680	PTA25LS	£295.00
1060	530-680	PTA25LM	£295.00
1160	530-680	PTA25L	£295.00



**RAPID  
DELIVERY**

LLT236818  
£655

**2300kg**  
CAPACITY

## Extra Long Hand Pallet Truck

- ✓ Heavy duty 2300kg capacity
- ✓ Top quality pallet truck ideal for warehouse, industrial and agricultural environments

- Manufactured in high grade steel with powder coated finish
- Ergonomic comfortable steer handle
- Lift height 85-210mm • Fork widths 520 or 680mm
- Fork lengths 1500, 1800, 2000, 2300, 2500, 3000mm
- Smooth running nylon load & steer wheels
- Polyurethane, rubber and steel wheels available on request

FORK LENGTH (mm)	WIDTH OVER FORKS (mm)	ORDER REF	PRICE
1500	520	LLT235215	£545.00
1800	520	LLT235218	£655.00
2000	520	LLT235220	£785.00
2300	520	LLT235223	£845.00
2500	520	LLT235225	£885.00
3000	520	LLT235230	£1095.00
1500	680	LLT236815	£545.00
1800	680	LLT236818	£655.00
2000	680	LLT236820	£785.00
2300	680	LLT236823	£845.00
2500	680	LLT236825	£885.00
3000	680	LLT236830	£1095.00



## Fully Powered Pallet Truck

✓ Quality designed powered pallet truck ideal for busy warehouse environments

- 1300kg capacity • Powered lift and drive
- Electronic speed control, uses necessary power without wasting battery life
- Fork widths 540 and 680mm • Fork lengths 1000 or 1150mm
- Maximum speed 5.0km/h laden, 5.2km/h unladen
- Raised fork height 205mm • Lowered fork height 85mm
- Battery 2 x 12volt/60Ah

REF LEPT13 PRICE £2995.00



LEPT13  
£2995

On-board charging option  
available, Please enquire

## ROBUR

### Powered Pallet Trucks

✓ Quality powered pallet truck for busy environments and frequent pallet handling

- Capacity 1500 - 1800 - 2000 - 2200 - 3000kg
- Powered lift and drive • Standard & heavy duty models
- Spring loaded drive wheel • Electromagnetic braking
- Electronic speed control • Tandem load rollers

- ✓ Demonstration available
  - ✓ On-site service available
  - ✓ Certificated training available
- Please call us for details!

★ NEW ★  
PRODUCT



Rider platform option

### Optional Extras

- Capacities: 4000, 5000 or 6000kg
- Fork widths to 1000mm • Fork lengths to 2000mm
- Hinged driver platform • Stand-in/ sit-down
- Explosion proof model • Reel handler • Low profile
- Hinged rider platform, all models except K9TE15



K9TE15  
£4303

INCLUDES BATTERY  
& INTEGRAL CHARGER

CAPACITY (kg)	TYPE	FORK DIMENSIONS L x W (mm)	MAXIMUM SPEED km/h	BATTERY	ORDER REF	PRICE
1500	STANDARD	1150 x 550	6	90Ah 24V	K9TE15	£4303.00
2000	STANDARD	1150 x 550	6	160Ah 24V	K9/TL20	£6565.00
2200	HEAVY DUTY	1150 x 550	6	160Ah 24V	K9/SBM/22	£7534.00
3000	HEAVY DUTY	1150 x 550	6	160Ah 24V	K9/SBM/30	£8385.00





## High Lift Pallet Trucks



FROM  
**£443**

FROM  
**£1161**

### Record HL1000 / EHL1000 High Lift Pallet Trucks

✓ A budget priced high lift pallet truck with no compromise on quality

- Capacity 1000kg • Lift height 800mm
- Fork Widths 520 & 685mm • Fork length 1200mm
- Nylon wheels • Compact 'A' Frame
- Two stage lift ram
- Available in manual or electric lift
- Electric models come complete with charger



Many other sizes, capacities & wheel options available from stock. Please enquire!

FORKS W x L (mm)	LIFT	ORDER REF	PRICE
520 x 1200	Manual	HL1000520	£443.00
685 x 1200	Manual	HL1000685	£456.00
520 x 1200	Electric	EHL1000520	£1161.00
685 x 1200	Electric	EHL1000685	£1175.00



**RAPID  
DELIVERY**  
ON SELECTED ITEMS

HLH1000/5411  
**£703**



★ **NEW** ★  
**PRODUCTS**

FORKS W x L (mm)	LIFT	ORDER REF	PRICE
540 x 1150	MANUAL	HLH1000/5411	£703.00
540 x 1150	BATTERY	HLB1000/5411	£1656.00

### ROBUR

#### High Lift Pallet Trucks

✓ Combined conventional pallet truck for general handling and work positioner for production and loading areas

- Capacity 1000kg • Lift height 800mm
- Hand or battery lift • Lateral safety brake
- Fixed stabilisers at operational height
- For use with non-bottom-boarded pallets
- 685mm width available

HLB1000/5411  
**£1656**

**WITH BATTERY AND  
BUILT-IN CHARGER**



## Heavy Duty High Lift Pallet Trucks

✓ Premium quality high-lift pallet trucks with innovative design features

- Slender neck allows all-round access to the load and a tight turning circle
- Designed and built in Europe to the highest standards to withstand the rigours of continuous use
- Operates as a conventional pallet truck but allows the load to be lifted to a comfortable working height for pallet loading and unloading
- Capacity 1500kg • Lift height 800mm • Fork widths 540 and 680mm
- Fork length 1200mm as standard, 700, 900 and 1520mm options available
- Low overall height • Tandem wheels on scissor legs
- Support stabilisers in raised model

★ NEW  
★ RANGE

HL540  
£702



**RAPID  
DELIVERY**

EHL540  
£1751



EHN540  
£2425



Bespoke lift heights, sizes and capacities are available to special order. The options are limitless. Please enquire

## EHN Work Positioner

- Fitted with a photoelectric sensor to detect the top of the load keeping it at a constant height
- With the truck in 'auto raise' mode the forks will automatically rise as the goods are unloaded
- In 'auto lower' mode, the forks will automatically lower as the goods are loaded
- In 'manual' mode the forks can be raised and lowered by means of push-buttons on the handle
- Safety interlocks are provided to prevent accidents whilst in automatic modes

### STAINLESS STEEL OPTION



### REMOTE CONTROL OPTION



### 1500kg High Lift Pallet Trucks

FORK WIDTH (mm)	LIFT TYPE	ORDER REF	PRICE
540	MANUAL	HL540	£702.00
680	MANUAL	HL680	£702.00
540	ELECTRIC	EHL540	£1751.00
680	ELECTRIC	EHL680	£1751.00
540	AUTOMATIC ELECTRIC	EHN540	£2425.00
680	AUTOMATIC ELECTRIC	EHN680	£2425.00

GEL FILLED BATTERY & INBUILT CHARGER REF HLGB PRICE £238.00

### Technical Specifications

SPECIFICATION	HL	EHL	EHN
Lifting Capacity kg	1500kg	1500kg	1500kg
Light Height mm	800mm	800mm	800mm
Turning Angle °	230°	180°	180°
Lifting Speed	10/35 mm per pump action	0.05m/sec with load 0.08m/sec with load	10.05m/sec with load 0.08m/sec with load
Aisle Width	1830mm (1200 x 800 pallet)	1890mm	1890mm
Motor	n/a	0.9kW 12V	0.9kW 12V
Total Weight	95kg	104kg	104kg

**Options include:** fork widths to 950mm, fork lengths to 2000mm, stainless steel construction, explosion-proof specification, remote control, bespoke design,





## Ergo Work Positioners

★ NEW ★  
RANGE

## Work Positioners, Tilters &amp; Rotating Forks

✓ Designed specifically to combat operator handling strain injuries, this range of compact, versatile work positioners, tilters and rotators will go a long way towards lowering fatigue and meeting health and safety requirements.

- Available in manual, semi and fully powered forms
- Manufactured to the highest quality standards

**LF920 Manual lift & traction**

- Compact work positioner
- Standard fork width 560mm
- Capacity 1000kg
- Lift height 920mm
- Full range of handling accessories
- Straddle fork option

LF920  
£1261LF MANUAL  
VERSION**RAPID  
DELIVERY**ELF920  
£2093

ELF POWERED LIFT

**ELF920 Electric Lift**

- Powered lift version of the above

**ELF920T Electric Lift & Tilt**

- Ideal for use with rotators (180° each way), clamps etc

**SELF920T Fully Powered**

- Options include straddle legs and stainless steel

ELF920T  
£4629SELF920T  
£7733SELF FULLY POWERED  
TILT UNIT, PALLET NOT  
INCLUDEDLT1000TE  
£2855ELF LOGITILT, STRADDLE  
LEG OPTION SHOWN  
WRAPOVER AS STANDARD**LT1000TE Logitilt**

- The Logitilt can carry, lift and tilt crates and boxes up to 90°, work height can be varied
- Capacity 1000kg
- Options - straddle legs and stainless steel



Bespoke lift heights, sizes and capacities are available to special order. The options are limitless. If you don't see what you are looking for, please call

Options include: straddle legs, stainless steel construction on most models, bespoke design



Crane Bar



Drum Lifter



Reel Clamp



Drum Forks

**Ergo Work Positioners**

FORK WIDTH (mm)	LIFT / FORK TYPE	ORDER REF	PRICE
560	MANUAL LIFT	LF920	£1261.00
560	ELECTRIC LIFT	ELF920	£2093.00
560	ELECTRIC LIFT/TILT	ELF920T	£4629.00
560	FULLY POWERED	SELF920T	£7733.00

**Accessories**

DESCRIPTION	ORDER REF	PRICE
LIFT HEIGHT INCREASED TO 1200mm	ERL1200	£80.00
FORK WIDTH 685mm	ERW685	£227.00
STRADDLE LEGS	ERST	£556.00
GEL FILLED BATTERY & INBUILT CHARGER	LFGB	£POA
AUTOMATIC LOAD HEIGHT CONTROL	LFHC	£624.00
LOGITILT	LT1000TE	£2855.00

POA = PRICE ON APPLICATION





## 500kg Manual Lift Stacker

✓ Economy hand pushed, hand lift stacker.  
The ideal value-for-money handling solution.

- Capacity: 500kg @ 400mm load centres
  - Lift height 1600mm
  - Lowered fork height 85mm
  - Maximum height 2000mm
  - Forks 800mm long - adjustable
  - Overall length (inc. forks) 1340mm
  - Overall width 890mm
  - Nylon front load rollers
- Polyurethane rear castor wheels (inc. brake)
- Foot & hand integral pump
- Safety mast-mounted push handle

### 500kg Manual Lift Stacker

LIFT HEIGHT (mm)	LOWERED MAST HEIGHT (mm)	ORDER REF	PRICE
1600	2000	M/500	£1007.00

**RAPID  
DELIVERY**

★ **NEW** ★  
**PRODUCTS**



- ✓ Demonstration available
  - ✓ On-site service available
  - ✓ Certificated training available
- Please call us for details!



## 1000kg Manual Lift Stacker

✓ Hand pushed, manual lift stacker - a cost effective handling solution for vehicle loading and production areas.

- Capacity: 1000kg @ 585mm load centres
  - Lift height 1500mm
  - Lowered fork height 85mm
  - Maximum height 1964mm
  - Forks 1150 x 540mm - fixed
  - Overall length (inc. forks) 1604mm
  - Overall width 760mm
  - Vulkollan front load rollers
- Vulkollan rear castor wheels (inc. brake) also with integral tiller handle pump
- Twin lift safety chains
- Safety mast-mounted push handle

### 1000kg Manual Lift Stacker

LIFT HEIGHT (mm)	LOWERED MAST HEIGHT (mm)	ORDER REF	PRICE
1500	1964	M/1510	£1314.00



## Manual & Battery Lift Stackers

### Manual Stackers

✓ A solid construction manual stacker suitable for many applications - off loading lorries, warehouse, production or occasional use

- Turning radius of 1088mm
- Hard wearing polyurethane wheels
- High quality hand pump
- Quick lift pump
- Capacity 500kg or 1000kg
- Lift height, 1500mm or 2900mm
- Wrap over fork design for euro pallets



CTM0515  
**£833**

**300kg**  
CAPACITY

CAPACITY (kg)	LIFT HEIGHT (mm)	FORK LENGTH (mm)	O/A FORK WIDTH (mm)	ORDER REF	PRICE
500	1500	1150	540	CTM0515	£833.00
1000	1500	1150	540	CTM1015	£993.00
1000	2900	1150	540	CTM1029	£1220.00

**RAPID  
DELIVERY**



Straddle legs for closed board pallets and adjustable forks are available, please enquire

### Electric Stackers

✓ A well designed robust electric lift stacker, for lots of different applications - off loading lorries, warehouse, production and racking

- Capacity 1000kg
- Lift heights 1600mm to 3300mm
- Wrap over fork design for euro pallets
- Manual steering light and easy
- Safety guards on the load rollers and steer wheels
- Battery 12volt/120ah
- Charger 12volt/12a



CTE1016  
**£1600**

**1000kg**  
CAPACITY

CAPACITY (kg)	LIFT HEIGHT (mm)	FORK LENGTH (mm)	O/A FORK WIDTH (mm)	ORDER REF	PRICE
1000	1600	1200	540	CTE1016	£1600.00
1000	2450	1200	540	CTE1024	£2000.00
1000	2900	1200	540	CTE1029	£2067.00
1000	3100	1200	540	CTE1031	£2133.00
1000	3300	1200	540	CTE1033	£2200.00



## Manual & Electric Stackers

- ✓ Robust and stable design, with excellent handling characteristics
- ✓ Small turning circle and low unladen weight
- ✓ Ideal for lifting and transporting

★ NEW ★  
RANGE

**RAPID  
DELIVERY**

FROM  
£1327

LF  
MANUAL  
VERSION

### LF Range

- Lift capacities up to 1000kg • Lift heights to 3300mm
- Manual, semi-powered, fully-powered and air options available
- Ergonomic handle design • Instant stop when lowering
  - Standard fork width 560mm, length 1150mm
- Supplied with fixed, wrapover forks - straddle available
- Options include adjustable forks, stainless steel construction
  - Compact overall size means easy manoeuvrability

- Two lifting speeds, normal and quick lift
- Infinitely adjustable lowering speed
- Pneumatic version can be connected to an airline for raising and lowering of forks

### ELF Range

- Stepless acceleration and braking
- Supplied with battery and internal charger
- Automatic brake activated by steering arm
- Safety switch automatically reverses drive should the operator become trapped against an obstruction • Smooth, quiet operation

ELF  
POWERED LIFT



FROM  
£2304



STRADDLE LEG  
OPTION



SIDE TILT  
OPTION



STAINLESS  
STEEL  
OPTION

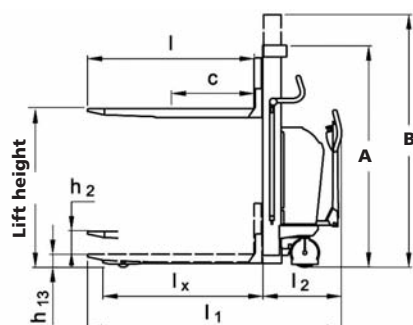

LIFT HEIGHT (mm)	A	B	LF PRICE	ELF PRICE	SELF PRICE
1600	1930	1930	£1327	£2304	£5549
1910	2240	2240	£1509	£2496	£5753
2050	1530	2490	£1801	£2588	£5727
2450	1730	2890	£1996	£2655	£5776
2850	1930	3290	-	£2749	£5836
3300	2240	3740	-	£2991	£6224

Options include other lift heights, 1200kg capacity, special forks, straddle legs, weighing device, heavy duty batteries, stainless steel construction, bespoke design, side tilting forks, crane arm, spear, drum rotator, remote control

FROM  
£5549

SELF  
FULLY POWERED  
LIFT AND TRACTION



TECHNICAL SPECIFICATION	
FORK LENGTHS	600, 800, 1150 and 1520mm
LIFT CAPACITY	Up to 1000kg @ 600mm load centres
LIFT HEIGHT	Up to 3300mm
TURNING ANGLE	SELF 210°, ELF 180°
GANGWAY	Factory fitted tests show a very compact aisle width of 1700mm
MOTOR	B1.1kW 12V (ELF/ELFS) 1.2kW 24V (SELF/SELFS)





## Battery Lift Stackers

### Battery Lift Stackers

- ✓ Hand pushed, battery lift stackers - ideal for vehicle loading, pallet stacking and serving mezzanine floors.

- Capacity: 1000kg @ 600mm load centres
- Lift heights: 1600 - 2500 - 3000mm • Fast lift, controlled lowering
- Large capacity battery • Low noise levels
- Wheel mounted parking brake • Vulkollan wheels & load rollers
- Rear wheel tiller steering • Built-in charger

#### Dimensions & Data

- Forks: 540 x 1180mm • Overall length: 1835mm
- Overall truck width: 800mm • 90° aisle 1000mm load: 1980mm
- Lift speed: 0.15m/sec

#### Optional Extras

- Straddle legs gap: 850, 1050, 1250mm
- Fixed I.T.A. carriage with adjustable forks

LIFT HEIGHT (mm)	LOWERED MAST HEIGHT (mm)	ORDER REF	PRICE
1600	1980	B/1610	£2643.00
2500	1750	B/2510	£3074.00
3000	2000	B/3010	£3405.00

Price includes Battery & Charger

**RAPID  
DELIVERY**  
ON SELECTED ITEMS



- ✓ Demonstration available
  - ✓ On-site service available
  - ✓ Certificated training available
- Please call us for details!

★ NEW ★  
PRODUCTS

B/1610  
£2643

INCLUDES  
BATTERY &  
INTEGRAL  
CHARGER



SBX/1608  
£3942

INCLUDES  
BATTERY &  
INTEGRAL  
CHARGER

### Compact Powered Stacker

- ✓ Extremely economical and highly versatile  
✓ Value for money solution for frequent handling of loads up to 800kg

- Capacity: 800kg @ 600mm load centres
- Lift height 1600mm fixed mast • Powered lift & drive
- Electronic speed control • Heavy duty 24V electrics
- Fast lift and lowering • Electric horn
- Battery & integral charger

#### Dimensions & Data

- Forks: 540 x 1180mm • Overall length: 1882mm
- Overall truck width: 825mm
- 90 degree aisle 1000mm load 1980mm
- Lift speed 0.15m/sec
- Maximum travel speed 8km/hr

LIFT HEIGHT (mm)	LOWERED MAST HEIGHT (mm)	ORDER REF	PRICE
1600	1990	SBX/1608	£3942.00

Price includes Battery & Charger



A carriage charge applies to this product, please contact us

**FROM  
£1393**

## Record VVR1000 / VVE1000 Heavy Duty Pallet Stackers

✓ A comprehensive range of heavy duty, European built stackers at a budget price. Available in manual or electric lift

- Capacity 1000kg to 1600kg
- Lift heights from 1600 to 3500mm
- Manual or electric lift
- Available with straddle legs. Leg spacings available in 850, 1050 & 1250mm
- Electric models come complete with heavy duty battery and built in battery charger
- All models can be fitted with ITA Class 2 carriages to allow the fork spacing to be adjusted



Straddle leg models available for lifting 4-way entry and other closed boarded pallets.

**★ NEW ★  
RANGE**

LIFT HEIGHT (mm)	CAPACITY* (kg)	MANUAL LIFT		ELECTRIC LIFT	
		ORDER REF	PRICE	ORDER REF	PRICE
1600	1000	VVR10001600	£1393.00	VVE10001600	£1951.00
2000	1000	VVR10002000	£1736.00	VVE10002000	£2313.00
2500	1000	VVR10002500	£1860.00	VVE10002500	£2473.00
3000	1000	VVR10003000	£1967.00	VVE10003000	£2531.00
3500	1000	VVR10003500	£2155.00	VVE10003500	£2720.00

\*Capacity is reduced with lift heights over 1600mm



Many other sizes, capacities and wheel options available from stock, please enquire

**RAPID  
DELIVERY**  
ON SELECTED ITEMS

## Record CL10 / CL12 Fully Powered Stackers

- Capacity 1000kg or 1200kg
- Capacity of up to 2000kg to order... Just call us
- Fork size 560 x 1150mm - ideal for Euro pallets
- Smooth, stepless acceleration and braking
- Emergency instant stop and automatic reverse for your protection
- Available with straddle legs. Leg spacing available in 850, 1050 and 1250mm
- Electric models complete with battery and built in battery charger
- All models can be fitted with ITA Class 2 carriages to allow the fitment of forged forks or other standard attachments (see below)

**FROM  
£5280**

Straddle leg models available for lifting 4-way entry and other closed boarded pallets. Shown here with ITA carriage and forged forks.



CAPACITY* (kg)	LIFT HEIGHT (mm)	MAST CONFIGURATION	ORDER REF	PRICE
1000	1600	Simplex	CL10.16	£5280.00
1000	2400	Duplex	CL10.24	£6040.00
1000	3200	Duplex	CL10.32	£6196.00
1000	3600	Duplex	CL10.36	£6351.00
1200	1600	Simplex	CL12.16	£5933.00
1200	2400	Duplex	CL12.24	£6680.00
1200	3200	Duplex	CL12.32	£6829.00
1200	3600	Duplex	CL12.36	£6981.00

\*Capacity is reduced with lift heights over 2400mm



## Powered Stackers

## Powered Stackers

✓ Highly practical powered lift and drive stackers for effortless handling of loads to 1000kg. Excellent manoeuvrability combined with fast lift & lowering provides a cost-effective solution for frequent handling.

- Capacity: 1000kg @ 600mm load centres
- Lift heights: 1600mm fixed mast, 2500 or 3000mm duplex mast
  - Powered lift and drive • Electronic speed control
- Heavy duty 24V electrics • Spring loaded drive wheel
- Excellent manoeuvrability • Fast lift and lowering
  - Electric horn • Battery & built in charger

### Dimensions & Data

- Forks: 540 x 1180mm • Overall length: 1930mm
- Overall truck width: 850mm • 90° aisle 1000mm load: 1980mm
- Maximum lift speed: 0.15m/sec • Maximum travel speed: 8km/hr

LIFT HEIGHT (mm)	LOWERED MAST HEIGHT (mm)	ORDER REF	PRICE
1600	1990	SBX/1610	£4836.00
2500	1740	SBX/2510	£5704.00
3000	1990	SBX/3010	£6002.00

Price includes Battery & Charger



★ NEW ★  
**PRODUCTS**



A carriage charge applies to the products on these pages, please contact us

## Heavy Duty Powered Stackers

✓ A complete range of heavy duty powerlift and drive stackers for fast & frequent handling within a wide range of working environments

✓ High capacities and many height options ensure maximum versatility

- Capacity: 1200, 1600 & 2000kg @ 600mm load centres
  - Lift heights: 1600mm, 2500, 3000, 4000mm
- Powered lift and drive • Heavy duty 24V electrics
- Electronic speed control • Electromagnetic braking
  - Electric horn • Battery discharge indicator
- Operator's safety button • Safety top speed limiter
  - Heavy duty battery & charger

### Dimensions & Data

- Forks: 540 x 1180mm • Overall length: 1980mm
- Overall truck width: 850mm • 90° aisle 1000mm load: 2150mm
- Maximum lift speed: 0.20m/sec • Maximum travel speed: 8km/hr

### Optional Extras

- 3000kg capacity • Lift heights up to 5800mm
- Full free lift mast • Triplex mast • Shorter forks
- Straddle legs 850, 1050, 1250mm • ITA carriage
  - Adjustable forks • Hinged platform

CAPACITY (KG)	LIFT HEIGHT (mm)	LOWERED MAST HEIGHT (mm)	ORDER REF	PRICE
1200	2500	1740	SB/2512	£7540.00
1200	3500	2250	SB/3512	£7872.00
1600	2500	1750	SBMVT/2516	£8704.00
1600	3500	2250	SBMVT/3516	£8964.00
2000	3000	1990	SBP/3020	£11830.00

Price includes Battery & Charger



Optional straddle legs

INCLUDES  
BATTERY &  
INTEGRAL  
CHARGER

SB/2512  
**£7540**







SBC/C1606  
£11434

INCLUDES  
BATTERY &  
CHARGER

## Compact Counterbalanced Stackers

✓ Ultra-compact counterbalanced stackers capable of handling single and double sided pallets. Ideal for environments where space is at a premium

- Capacity: 600kg • Chassis only 940mm
- Lift heights: 1600, 2500, 3000mm • Non tilt mast
- Dual lowering system • Electronic speed control
- Load back rest • Electric horn • Battery discharge indicator

### Dimensions & Data

- Forks: 1000mm • Chassis length: 940mm
- Truck width: 850mm • 90 aisle 1000mm load: 2150mm
- Maximum lift speed: 0.25m/sec • Maximum travel speed: 6km/hr

LIFT HEIGHT (mm)	LOWERED MAST HEIGHT (mm)	ORDER REF	PRICE
1600	2100	SBC/C1606	£11434.00
2500	1780	SBC/C2506	£11798.00
3000	2020	SBC/C3006	£12480.00



We offer a comprehensive training programme including stackers and fork lift truck driver training (instructors are RTITB qualified) stairclimbers, manual handling and refresher courses. Call us for details!



A carriage charge applies to these products, please contact us

★ NEW ★  
**PRODUCTS**

## Counterbalanced Stackers

✓ Cost effective and flexible solutions for handling all pallet designs. Does the work of a forklift at much lower cost.

- Capacity: 600-1000-1200kg @ 600mm load centres
- Lift heights: 1600mm fixed mast, 2500 or 3000mm duplex mast
  - Tilting mast • Powered lift and drive
  - Adjustable forks • Electronic speed control
  - Electromagnetic braking • Operator safety button
- Suitable for most pallet designs • Battery discharge indicator

### Dimensions & Data

- Fork length: 1000mm • Chassis length: 1270 or 1470mm
- Truck width: 850mm • Maximum lift speed: 0.2-0.25m/sec
- Maximum travel speed: 6km/hr

### Optional Extras

- Compact 600kg chassis - 960mm • Side shift • Full free lift masts
- Triplex mast - 4500mm lift • Explosion proof

### Simplex Mast

- 1600mm lift height • 2050mm lowered mast height

CAPACITY @ 600mm L.C.	MAXIMUM LIFT SPEED (meters/sec)	ORDER REF	PRICE
600kg	0.25	SBC/1606	£11694.00
1000kg	0.20	SBC/1610	£12376.00
1200kg	0.20	SBC/1612	£12675.00

### Duplex Mast

- 2500mm lift height • 1770mm lowered mast height
- 3000mm lift height • 2020mm lowered mast height

CAPACITY @ 600mm L.C.	LIFT HEIGHT (mm)	MAX LIFT SPEED (meters/sec)	ORDER REF	PRICE
600kg	2500	0.25	SBC/2506	£12025.00
600kg	3000	0.20	SBC/3006	£12376.00
1000kg	2500	0.20	SBC/2510	£12805.00
1000kg	3000	0.20	SBC/3010	£13130.00
1200kg	2500	0.20	SBC/2512	£13286.00
1200kg	3000	0.20	SBC/3012	£13429.00

Price includes Battery & Built-in Charger



SBC/1606  
£11694

INCLUDES  
BATTERY &  
CHARGER



## Electric Mini Lifter



**FROM  
£1880**

UP TO  
**200kg**  
CAPACITY

**BUDGET**

**RAPID  
DELIVERY**

**ALL STAINLESS STEEL  
MODEL AVAILABLE  
(ITE10015SS)**



## Electric Mini Lifter

- ✓ Designed for ultimate flexibility, used in a wide range of functions for production, warehousing and office environments
- ✓ Large range of attachment options to suit most lifting applications
  - Capacities of 100 or 200kg
  - Lift heights of 1500 or 2000mm
  - Simple controls all mounted within easy reach of the operator
- Standard truck is equipped with forks, a Oil and coil handler accessory can be fitted instead at no extra cost - please specify
  - Attachments are easily and quickly changed with simple tools
  - Fully floating castors allow for operation in very tight areas
  - The built in battery charger allows the truck to be charged from any convenient 13 amp socket
  - Option of front swivel wheels

CAPACITY (kg)	MAX LIFT H (mm)	BATTERY v/ah	CHARGER v/a	ORDER REF	PRICE
100	1500	2 x 12/17	24/6A	ITE10015	£1880.00
100	2000	2 x 12/17	24/6A	ITE10020	£2676.00
200	1500	2 x 12/40	24/6A	ITE20015	£2575.00
100	1500	2 x 12/17	24/6A	ITE10015SS	£3564.00

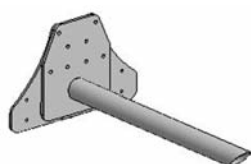

**Roll & Coil Handler**

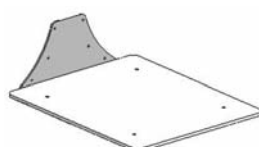

**Work Platform**



**Jib Crane Arm**

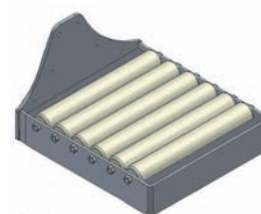

**Roller Bed Platform**



**Drum & Roll Turner**

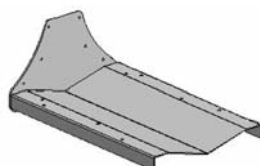

**Bevelled Platform**

### Accessories

DESCRIPTION	TO SUIT MODEL/S				ORDER REF	PRICE
	10015	10020	20015	10015SS		
ROLL & COIL HANDLER	✓	-	✓	✓	ITES	£109.00
WORK PLATFORM	✓	✓	✓	✓	ITEP	£120.00
JIB CRANE ARM	✓	-	-	✓	ITEG	£455.00
ROLLER BED PLATFORM	✓	-	-	✓	ITEC	£629.00
DRUM & ROLL TURNER	✓	✓	✓	✓	ITER	£1063.00
BEVELLED PLATFORM	✓	✓	✓	✓	ITEB	£156.00



## Pallet Pal Level Loader

✓ A unique power-free automatic level loader. Simple, robust and efficient.



P-PAL  
£1766

SUITS PALLET  
LOADS FROM  
200kg - 2000kg



P-BELL  
£440

- Integral turntable allows operator to turn the load and always work from the nearside
  - Eliminates bending and stretching associated with loading pallets at floor level
- Heavy duty springs maintain the top of the pallet load at a comfortable working height
  - As the load increases the platform goes down, as the load decreases it goes up
- Suitable for applications with fork truck access and pallet loads between 200-2000kg
- Requires no floor fixings • Overall size - 1110W x 1220Lmm • Turntable 1100 dia
  - Maximum height 700mm • Lowered height 240mm • Unit weight - 160kg

REF P-PAL PRICE £1766.00

### Bellows Guard

- Encloses mechanism and prevents dirt ingress
- Simply fits over the Pallet Pal
- Concertina design moves with the Pallet Pal

REF P-BELL PRICE £440.00

## Pal-Disc Pallet Turntable



P-DISC  
£913

- ✓ Ramped edge for easy pallet truck loading
- ✓ Ultra low profile ideal in space confined areas
- Free turning - does not tighten or bind under load
- 2000kg capacity • Virtually maintenance free
- Lock prevents accidental rotation • Tine lug included
- Height 22mm • Overall diameter 1240mm
- Turntable diameter 1100mm • Unit weight 100kg

REF P-DISC PRICE £913.00



Tine Lug screws  
into centre boss for  
fork truck lifting

## Pal-Ring Pallet Turntable

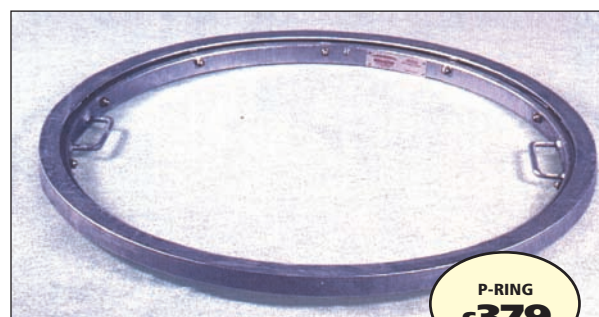

P-RING  
£379

- ✓ Simple and cost effective
- ✓ Ideal for pallet loading and stripping
- Robust, lightweight construction
- Free turning - does not tighten or bind under load
- Supplied either with handles or bolt down lugs for floor fixing
- Can be adapted to suit a variety of applications, including mounting onto a scissor lift
- Height 60mm • Overall diameter 1110mm
- 2000kg capacity • Unit weight 25kg

REF P-RING PRICE £379.00





## Castors

**RAPID  
DELIVERY**

- All castors in a pressed steel zinc plated finish
- Double ball race swivel heads as standard
- All sizes and wheel diameters catered for
- Top plate and single bolt hole fixings on most models
- Swivel wheel brakes available on most models



Please call us for  
any type of castor  
you need!

### Light Duty White Polypropylene Castors, Top Plate Fitting

WHEEL DIA	CAP (kg)	O/A HEIGHT	TOP PLATE	B/HOLE CENTRES	SWIVEL REF	FIXED REF	SWIVEL BRAKED REF
50	50	72	50x50	36x36	BZD50NY £1.90	- -	BZD50NYSWB £2.30
75	70	95	75x60	55x42	BZD75NY £3.10	BZDF75NY £2.60	BZD75NYSWB £3.70
100	125	128	102x84	80x60	BZMM100PL £3.80	BZMMF100PL £2.90	BZMM100PLSWB £7.10
125	160	155	102x84	80x60	BZMM125PL £5.00	BZMMF125PL £4.30	BZMM125PLSWB £8.10
160	200	190	135x110	105x80	BZMM160NY £12.10	BZMMF160NY £9.50	BZMM160NYSWB £15.30
200	250	235	135x110	105x80	BZMM200NY £14.20	BZMMF200NY £12.60	BZMM200NYSWB £18.10

### Light Duty Grey Non Marking Rubber Tyred Castors, Top Plate Fitting

WHEEL DIA	CAP (kg)	O/A HEIGHT	TOP PLATE	B/HOLE CENTRES	SWIVEL REF	FIXED REF	SWIVEL BRAKED REF
50	50	72	50x50	36x36	BZD50GR £2.10	- -	BZD50GRSWB £2.60
75	50	95	75x60	55x42	BZD75GR £3.20	BZDF75GR £3.70	BZD75GRSWB £3.70
100	70	128	102x84	80x60	BZMM100GR £4.70	BZMMF100GR £3.70	BZMM100GRSWB £6.90
125	100	155	102x84	80x60	BZMM125GR £6.30	BZMMF125GR £5.80	BZMM125GRSWB £8.90
160	160	190	135x110	105x80	BZMM160GR £12.60	BZMMF160GR £9.50	BZMM160GRSWB £15.80
200	250	235	135x110	105x80	BZMM200GR £13.70	BZMMF200GR £13.70	BZMM200GRSWB £18.40

### Light Duty Black Rubber Tyred Castors, Top Plate Fitting

WHEEL DIA	CAP (kg)	O/A HEIGHT	TOP PLATE	B/HOLE CENTRES	SWIVEL REF	FIXED REF	SWIVEL BRAKED REF
75	50	95	75x60	55x42	BZMM75BSB £2.80	BZMMF75BSB £2.30	BZMM75BSBBR £4.30
100	70	128	102x84	80x60	BZMM100BSB £4.20	BZMMF100BSB £3.30	BZMM100BSBSWB £6.10
125	100	155	102x84	80x60	BZMM125BSB £4.60	BZMMF125BSB £3.70	BZMM125BSBSWB £6.70
160	160	190	135x110	105x80	BZMM160BSB £11.60	BZMMF160BSB £8.40	BZMM160BSBSWB £14.70
200	250	235	135x110	105x80	BZMM200BSB £14.20	BZMMF200BSB £12.10	BZMM200BSBSWB £16.80

### LD White Polypropylene Castors, Bolt Hole Fitting

WHEEL DIA	CAP (kg)	O/A HEIGHT	BOLT DIA	SWIVEL REF	SWIVEL BRAKED REF
50	55	72	10	BZD50NYBH10 £1.90	BZD50NYBH10SWB £2.60
75	75	100	10	BZD75NYBH10 £3.20	BZD75NYBH10SWB £4.20
100	80	135	12	BZD100NYBH10 £5.20	BZD100NYBH10BR £5.80
125	125	155	12	BZD125NYBH10 £5.90	BZD125NYBH10BR £6.50

### LD Grey Non Marking Rubber Tyred Castors, Bolt Hole Fitting

WHEEL DIA	CAP (kg)	O/A HEIGHT	BOLT DIA	SWIVEL REF	SWIVEL BRAKED REF
50	50	72	10	BZD50GRBH10 £1.90	BZD50GRBH10SWB £3.20
75	70	100	10	BZD75GRBH10 £3.20	BZD75GRBH10SWB £4.20
100	80	135	12	BZD100GRBH10 £4.70	BZD100GRBH10BR £5.80
125	100	155	12	BZD125GRBH10 £5.30	BZD125GRBH10BR £6.30

### Expanders

- Add expanders to bolt hole castors to mount into steel tubing

#### SQUARE TUBE TYPE

21.5-24mm	EXPS21	£2.30
24-27mm	EXPS24	£2.30
27-30mm	EXPS27	£2.30
32-35mm	EXPS31	£2.30
36-40mm	EXPS36	£2.30

#### ROUND TUBE TYPE

19-21.5mm	EXPR19	£2.30
21.5-24mm	EXPR21	£2.30
24-27mm	EXPR24	£2.30
27-30mm	EXPR27	£2.30
31-35mm	EXPR31	£2.30

**Medium Duty White Nylon Castors, Top Plate Fitting**

WHEEL DIA	CAP (kg)	O/A HEIGHT	TOP PLATE	B/HOLE CENTRES	SWIVEL REF	FIXED REF	SWIVEL BRAKED REF
75	130	95	105x80	80x60	BZH75NY £3.40	BZHF75NY £2.80	BZH75NYBR £4.70
100	250	132	105x85	80x60	BZH100NYB £8.40	BZHF100NYB £5.30	BZH100NYBSWB £11.60
125	250	157	108x85	80x60	BZH125NYB £9.50	BZHF125NYB £6.30	BZH125NYBSWB £13.70
150	500	197	140x110	105x80	BZP150NYB £25.20	BZPF150NYB £18.40	BZP150NYBSWB £27.30
200	500	237	140x110	105x80	BZP200NYB £29.40	BZPF200NYB £23.60	BZP200NYBSWB £35.70

**Medium Duty Polyurethane Tyred Castors with Nylon Centres, Top Plate Fitting**

WHEEL DIA	CAP (kg)	O/A HEIGHT	TOP PLATE	B/HOLE CENTRES	SWIVEL REF	FIXED REF	SWIVEL BRAKED REF
100	150	132	105x85	80x60	BZH100NPB £12.60	BZHF100NPB £9.50	BZH100NPBSWB £16.80
125	200	157	108x85	80x60	BZH125NPB £14.70	BZHF125NPB £12.60	BZH125NPBSWB £18.90
150	400	197	140x110	105x80	BZP150NPB £29.40	BZPF150NPB £21.50	BZP150NPBSWB £32.60
200	500	237	140x110	105x80	BZP200NPB £38.90	BZPF200NPB £31.50	BZP200NPBSWB £41.00

**Medium Duty Polyurethane Tyred Cast Iron Castors, Top Plate Fitting**

WHEEL DIA	CAP (kg)	O/A HEIGHT	TOP PLATE	B/HOLE CENTRES	SWIVEL REF	FIXED REF	SWIVEL BRAKED REF
100	300	132	105x85	8	BZH100PTBJ £28.40	BZHF100PTBJ £26.30	BZH100PTBJSWB £31.50
125	300	157	105x85	8	BZH125PTBJ £31.50	BZHF125PTBJ £29.40	BZH125PTBJSWB £36.20
150	500	197	140x110	10	BZP150PTBJ £42.00	BZPF150PTBJ £36.80	BZP150PTBJSWB £47.30
200	500	237	140x110	10	BZP200PTBJ £49.40	BZPF200PTBJ £44.10	BZP200PTBJSWB £52.50

**MD White Nylon Castors, Bolt Hole Fitting**

WHEEL DIA	CAP (kg)	O/A HEIGHT	BOLT DIA	SWIVEL REF	SWIVEL BRAKED REF
100	150	128	12	BZH100NYBH12 £8.40	BZH100NYBH12BR £10.50
125	150	155	12	BZH125NYBH12 £8.40	BZH125NYBH12BR £11.60
160	200	195	12	BZHH160NYBH16 £18.90	BZHH160NYBH16BR £23.10
200	200	235	12	BZHH200NYBH16 £25.20	BZHH200NYBH16BR £42.00

**MD Rubber Tyred Nylon Castors, Bolt Hole Fitting**

WHEEL DIA	CAP (kg)	O/A HEIGHT	BOLT DIA	SWIVEL REF	SWIVEL BRAKED REF
100	150	128	12	BZH100RNBH12 £10.50	BZH100RNBH12BR £13.70
125	150	155	12	BZH125RNBH12 £14.70	BZH125RNBH12BR £15.80
160	200	195	12	BZHH160RNBH16 £21.00	BZHH160RNBH16BR £29.40
200	200	235	12	BZHH200RNBH16 £24.70	BZHH200RNBH16BR £31.50

**MD Polyurethane Tyred Nylon Castors, Bolt Hole**

WHEEL DIA	CAP (kg)	O/A HEIGHT	BOLT DIA	SWIVEL REF	SWIVEL BRAKED REF
100	150	128	12	BZH100NPBH12 £11.60	BZH100NPBH12BR £13.70
125	150	155	12	BZH125NPBH12 £12.60	BZH125NPBH12BR £14.70
160	200	195	12	BZH160NPBH12 £32.80	BZH160NPBH12BR £44.90
200	200	235	12	BZHH200NPBH16 £37.80	BZHH200NPBH16BR £42.00



## Freedom Lifters



**100kg**  
CAPACITY

**MANUAL**

**ADJUSTABLE  
FORK MODEL  
£650**



## FREEDOM LiftM8

✓ A revolutionary tool for light removal delivery work. Quick-change attachments make light work of a variety of tasks.

- The ideal commercial delivery tool for loads to 100kg
- Lightweight (under 20kg) steel and aluminium construction
- Removable legs allow machine to be positioned where others can only come close!
- Marine grade winch with "memory free" Kevlar rope
- Folding adjustable forks fitted as standard
- Suction cup and boom models also available



**BOOM MODELS  
FOR REELS &  
ROLLS**



**SUCTION CUP  
MODELS SUIT  
MANY SMOOTH  
SURFACE ITEMS**

### Freedom LiftM8

MODEL	MIN HEIGHT (mm)	MAX HEIGHT (mm)	OVER FORKS MIN/MAX (mm)	ORDER REF	PRICE
FORKS	40	1000	130/330	LM1001000FA	£650.00
SUCTION	200*	1150*	-	LM1001000SA	£784.00
BOOM	40	1000	-	LM1001000BA	£673.00

\* Lift height to the centres of suction cups

★ **NEW** ★  
**PRODUCTS**

## FREEDOM Light Duty Electric Stacker

✓ A 260kg capacity electric stacker which lifts to 1600mm. Unrivalled for specification against price!



**FREEDOM  
STACKER  
£1077**



**DUAL POSITION  
PLATFORM**

The stacker comes complete with fixed fork attachment as standard. This can be changed simply for any of the other "quick-change" attachments, including adjustable forks, tray, roller platform, boom and suction cups.

Freedom Stacker  
with standard platform  
**REF STVOYFR2616PLAT**  
**PRICE £1077.00**

Freedom Stacker  
with fixed forks  
**REF STVOYFR2616-E**  
**PRICE £969.00**

**260kg**  
CAPACITY

**ELECTRIC**

	<b>POSITION 2</b>
	Lowered height 440mm Raised height 1950mm Maximum capacity 120kg
	<b>POSITION 1</b>
	Lowered height 90mm Raised height 1600mm Maximum capacity 260kg



- Modular design makes the ideal multi-purpose stacker
- Handle electronic equipment, including de-boxing with manual suction cups
- Compact – fits through a normal doorway
- Single narrow mast for high visibility
- Dual position platform gives extra lift height
- Steering castors have total stop brakes
- Sealed gel battery and external charger
- Option of four swivel castors

### Freedom Stacker Attachments & Options

OPTIONAL ITEM	DIMENSIONS W x L (mm)	ORDER REF	PRICE
ADJUSTABLE FORKS	610 x 550	ST-VOY-FR-FORK	£127.00
ROLLER PLATFORM	600 x 615	ST-VOY-FR-RP	£256.00
BOOM	-	ST-VOY-FR-BOOM	£60.00
SUCTION CUPS	-	ST-VOY-FR-SUCT	£240.00
4 x SWIVEL CASTORS IN LIEU OF FIXED & SWIVEL	-	ST-VOY-FR-SWIV	£108.00



## BRITRUCK Light Duty Stackers

✓ Designed, developed and built to give long service with minimum maintenance

- Manual or battery electric operation
- Maximum lift heights of 1830mm or 2450mm
- Wrapover or adjustable fork arrangement
- High quality robust construction
- Designed for use in confined spaces, the twin mast allows entry through standard doorways
- Fitted with one brake as standard to prevent the stacker from moving when loading & unloading
- Quality British design & manufacture
- Forks 540L x 560Wmm on fixed model and 500L x 635Wmm max on adjustable fork model

FROM  
£646

250kg  
CAPACITY

MANUAL



Quality products  
British made with  
long life in mind

CAPACITY (kg)	LIFT HEIGHT (mm)	TYPE	FIXED FORKS / WRAPOVER		WIDE STRADDLE / ADJ. FORKS	
			ORDER REF	PRICE	ORDER REF	PRICE
250	1830	MANUAL	ST-250-1830-M	£646.00	ST250-1830-M-AD	£738.00
250	2450	MANUAL	ST-250-2450-M	£685.00	ST250-2450-M-AD	£777.00
250	1830	ELECTRIC	ST-250-1830-E	£1241.00	ST250-1830-E-AD	£1333.00
250	2450	ELECTRIC	ST-250-2450-E	£1280.00	ST250-2450-E-AD	£1372.00

## BRITRUCK Voyager Stackers

✓ The modern ergonomic solution for companies wishing to increase productivity whilst conforming to current health & safety legislation.

- Manual and electric models available
- A wider straddle option available for special applications
- Anodised finish is safe for use in clean environments
  - High visibility single, narrow mast
- Constructed from lightweight modular aluminium for ease of operation
- 125mm dia poly castor wheels, 2 with brakes
- 700 - 900mm distance across standard legs
- Adjustable 1600mm max distance across straddle leg option

FROM  
£1402



UP TO  
1000kg  
CAPACITY

MANUAL  
& ELECTRIC  
MODELS

EXTRA WIDE  
STRADDLE LEGS

FROM  
£1487

### Wide Straddle Stacker

CAPACITY (kg)	LIFT HEIGHT (mm)	FORK L x W (mm)	TYPE	ORDER REF	PRICE
500	1100	1140 x 120	MANUAL	VOY500-1100M-SR	£1487.00
500	1600	1140 x 120	MANUAL	VOY500-1600M-SR	£1644.00
1000	1100	1160 x 150	MANUAL	VOY1000-1100MSR	£1694.00
1000	1600	1160 x 150	MANUAL	VOY1000-1600MSR	£1850.00
500	1100	1140 x 120	ELECTRIC	VOY500-1100E-SR	£2272.00
500	1600	1140 x 120	ELECTRIC	VOY500-1600E-SR	£2428.00
1000	1100	1160 x 150	ELECTRIC	VOY1000-1100ESR	£2478.00
1000	1600	1160 x 150	ELECTRIC	VOY1000-1600ESR	£2634.00

### Standard Stacker

CAPACITY (kg)	LIFT HEIGHT (mm)	FORK L x W (mm)	TYPE	ORDER REF	PRICE
500	1100	1140 x 120	MANUAL	VOY500-1100M	£1402.00
500	1600	1140 x 120	MANUAL	VOY500-1600M	£1559.00
1000	1100	1160 x 150	MANUAL	VOY1000-1100M	£1609.00
1000	1600	1160 x 150	MANUAL	VOY1000-1600M	£1765.00
500	1100	1140 x 120	ELECTRIC	VOY500-1100E	£2187.00
500	1600	1140 x 120	ELECTRIC	VOY500-1600E	£2343.00
1000	1100	1160 x 150	ELECTRIC	VOY1000-1100E	£2393.00
1000	1600	1160 x 150	ELECTRIC	VOY1000-1600E	£2549.00



## Mobile Scissor Tables

### ELEVATION Mobile Scissor Lift Tables

- ✓ High quality UK manufactured mobile scissor tables which conform to all relevant EU regulations.  
These tables can be fitted with various extras – roller tops, bellows skirts, ball tops etc.



SC-800-D-M  
**£1741**

**DOUBLE SCISSOR**



**RAPID  
DELIVERY**



Quality products  
British made with  
long life in mind

- Manual hydraulic or battery electric models
- Toe guards fitted as standard
- Overload and slow lowering valves fitted as standard
- Nylon bushes fitted at all hinge points
- Special sizes available – call us with your requirements



**SINGLE SCISSOR**

**LIGHTWEIGHT  
ALUMINIUM  
SINGLE SCISSOR**



**TRIPLE SCISSOR**

#### Single Scissor Lift Tables

CAPACITY (kg)	OPERATION	CLOSED HEIGHT (mm)	RAISED HEIGHT (mm)	TABLE TOP SIZE (mm)	ORDER REF	PRICE
150	MANUAL	255	780	450 x 760	SC-150-S-M	£361.00
150	MANUAL	255	780	450 x 760	SC-150-S-M-ALU*	£561.00
300	MANUAL	335	840	500 x 840	SC-300-S-M	£557.00
300	BATTERY ELECTRIC	335	840	500 x 840	SC-300-S-E	£1482.00
500	MANUAL	340	900	610 x 1030	SC-500-S-M	£710.00
500	BATTERY ELECTRIC	340	900	610 x 1030	SC-500-S-E	£1635.00
800	MANUAL	360	1050	840 x 1350	SC-800-S-M	£1300.00
800	BATTERY ELECTRIC	360	1050	840 x 1350	SC-800-S-E	£2224.00
1000	MANUAL	360	1050	1000 x 2000	SC-1000-S-M	£1462.00
1000	BATTERY ELECTRIC	360	1050	1000 x 2000	SC-1000-S-E	£2387.00
1250	MANUAL	360	1050	840 x 1350	SC-1250-S-M	£1578.00
1250	BATTERY ELECTRIC	360	1050	840 x 1350	SC-1250-S-E	£2503.00

\* This model is manufactured from ALUMINIUM and weighs just 24kg

#### Double Scissor Lift Tables

CAPACITY (kg)	OPERATION	CLOSED HEIGHT (mm)	RAISED HEIGHT (mm)	TABLE TOP SIZE (mm)	ORDER REF	PRICE
125	MANUAL	430	1420	500 x 840	SC-125-D-M	£710.00
125	BATTERY ELECTRIC	430	1420	500 x 840	SC-125-D-E	£1635.00
300	MANUAL	295	1350	610 x 1030	SC-300-D-M	£761.00
450	MANUAL	295	1550	610 x 1030	SC-450-D-M	£854.00
450	BATTERY ELECTRIC	295	1550	610 x 1030	SC-450-D-E	£1779.00
500	MANUAL	490	1900	840 x 1350	SC-500-D-M	£1458.00
500	BATTERY ELECTRIC	490	1900	840 x 1350	SC-500-D-E	£2382.00
800	MANUAL	490	1900	840 x 1350	SC-800-D-M	£1741.00
800	BATTERY ELECTRIC	490	1900	840 x 1350	SC-800-D-E	£2666.00

#### Triple Scissor Lift Tables

CAPACITY (kg)	OPERATION	CLOSED HEIGHT (mm)	RAISED HEIGHT (mm)	TABLE TOP SIZE (mm)	ORDER REF	PRICE
500	MANUAL	650	2900	840 x 1350	SC-500-T-M	£2183.00
500	BATTERY ELECTRIC	650	2900	840 x 1350	SC-500-T-E	£3107.00



## Mobile Scissor Lift Tables Premium quality mobile scissor lift tables



- Twin braked castors
- Handle positioned precise lowering
- Maintenance lockout bar
- Polyurethane wheels
- 5 sizes available



SC200SMJCB  
£287



SC350DMJCB  
£524

350KG DOUBLE LIFT

**RAPID  
DELIVERY**

CAPACITY (kg)	PLATFORM L x W (mm)	MAX RAISED HEIGHT (mm)	MIN RAISED HEIGHT (mm)	WEIGHT (kg)	ORDER REF	PRICE
200	700 x 450	750	250	41	SC200SMJCB	£287.00
300	850 x 520	850	335	81	SC300SMJCB	£366.00
500	920 x 610	950	350	107	SC500SMJCB	£459.00
800	920 x 610	930	350	117	SC800SMJCB	£524.00
350	920 x 610	1610	430	134	SC350DMJCB	£524.00

## Low Profile Scissor Lifts

 Affordable solutions to the ever-present Health & Safety issues at the end of production lines

- Economic low profile pallet positioners
  - Ex stock supply
- Smooth, safe 415V 3-phase operation
- Safety cut-out bar under table edge



BD-HY-1001  
£1819



BD-HU-1000  
£1819

U-SHAPE TABLE FOR USE  
WITH EURO PALLETS

### Operational Notes

- These tables help to eliminate the bending caused where pallets are positioned on the floor until filled.
  - Position the pallet on the table, and elevate to the operators preferred working height.
  - As the load is added, the table is simply lowered with the pedestal mounted controller, maintaining the preferred working height

CAPACITY (kg)	TYPE	CLOSED HEIGHT (mm)	RAISED HEIGHT (mm)	TOP SIZE (mm)	WEIGHT (kg)	ORDER REF	PRICE
1000	U-SHAPE	85	860	1450 x 1140	295	BD-HU-1000	£1819.00
1000	TABLE WITH RAMP	85	860	1450 x 1140	280	BD-HY-1001	£1819.00



## Scissor Lifts

### Specialised Scissor Lifts

- ✓ We have a huge and diverse range of lifting platforms including lorry loaders and goods lifts as well as tilt and rotating units.
- ✓ FREE site visits, demonstrations, trials and showcase visits.



Take advantage of our knowledge! Our specialists are on-hand to help you make the right choice.

- ✓ Expert technical advice and on-going back-up
- ✓ 3 years parts and labour warranty
- ✓ Lowest cost of ownership
- ✓ Unrivalled customer support
- ✓ Proven reliability

Just call us!



### Budget Scissor Lift Tables

- ✓ Popular scissor lift models, competitively priced, and supplied from stock!

#### 500kg - 2000kg Scissor Lifts

- Premium quality products • Ex stock supply
- 415V 3-phase or 230V single phase, at no extra charge
- Tables comply with EN1570 European Standard
- CE marked • Low voltage control circuits
- Key switch prevents unauthorised use
- Easy push-button controls with emergency stop
- Safety trip bars lock table if descent is obstructed
- Fail safe automatic pressure relief valve
- Hose failure safety valve
- Mechanical stays for safe maintenance access

**RAPID  
DELIVERY**  
ON SELECTED ITEMS

ON SITE DEMO  
AVAILABLE



CL1001  
**£2006**

CAPACITY (kg)	CLOSED HEIGHT	RAISED HEIGHT (mm)	TOP SIZE (mm)	RISE TIME (seconds)	ORDER REF	PRICE
500	160	760	900 x 600	12	CR500	£1821.00
1000	160	760	900 x 700	23	CR1000	£2078.00
1000	180	1000	1200 x 800	15	CL1001	£2006.00
1500	210	1500	1500 x 1000	17	CB1500	£2726.00
2000	200	1020	1300 x 800	17	CL2000	£2508.00



## Scissor Lifts

✓ For machine feeding, stacking and loading, palletising and loading bays

✓ Safety is paramount, all models comply with EN1570 European Standard

- Low voltage control circuits
- CE marked • Hose failure safety valve
- Key switch prevents unauthorised use
- Easy push-button controls with emergency stop
- Safety trip bars lock table if descent is obstructed
- Fail safe automatic pressure relief valve
- Mechanical stays for safe maintenance access

Scissor Lifts are normally supplied for use on 380/420V 3-Phase supplies. Please enquire for 230V single phase

**RAPID  
DELIVERY**  
ON SELECTED ITEMS



### Single Scissor Models

- Often available from stock
- Our most widely used design
- May be used on the factory floor, or installed in a pit
- Special platform sizes quoted upon request
- Suitable for indoor or outdoor use



We specialise in specials. Call us for a quote to your specification!



### Single Scissor Lifts

CAPACITY (kg)	FOLDED (mm)	STROKE (mm)	PLATFORM SIZE L x W (mm)	RISE TIME (secs)	ORDER REF	PRICE
500	160	600	900 x 600	12	TR500	£2318
1000	180	820	1300 x 700	15	TL1000	£2614
1000	180	820	1300 x 800	15	TL1000B	£2642
1000	180	820	1300 x 1000	15	TL1000XB	£2784
1000	200	1300	2000 x 800	16	TA1000	£4062
1500	230	1100	1700 x 1000	17	TM1500	£3825
1500	230	1100	1700 x 1200	17	TM1500B	£4005
2000	200	820	1300 x 800	17	TL2000	£3306
2000	220	1000	1500 x 1200	26	TB2000B	£4185
2000	250	1500	2200 x 1200	27	TS2000	£5941
2000	250	1500	2200 x 1500	27	TS2000B	£6234
3000	250	1100	1700 x 900	27	TM3000	£4937
3000	300	1700	2500 x 1300	27	TT3000	£6896
4000	350	1300	2000 x 1200	27	TA4000	£8111
6000	300	1100	1700 x 900	32	TM6000*	£8406
6000	450	1600	2500 x 1300	40	TT6000	£14157
6000	500	2000	3000 x 1500	55	TP6000	£16195
10000	600	1100	2000 x 1100	40	TA10000*	£18619
10000	600	1500	2500 x 1300	55	TT10000*	£POA
10000	700	2200	3600 x 1500	72	TV10000*	£POA

\*These models have remote power packs, without cover. POA = Price on application

### Double Vertical Scissor Lifts

CAPACITY (kg)	FOLDED (mm)	STROKE (mm)	PLATFORM SIZE L x W (mm)	RISE TIME (secs)	ORDER REF	PRICE
200	280	1170	900 x 600	12	CRD200	£2121
400	280	1170	900 x 700	25	TRD400	£3607
1000	320	1600	1300 x 800	29	TLD1000	£3652
1500	450	3000	2200 x 1200	55	TSD1500	£8591
2000	360	1600	1300 x 800	34	TLD2000	£4840
3000	500	2200	1700 x 900	50	TMD3000*	£7733
4000	800	4000	3200 x 1500	76	TPD4000*	£POA
5000	700	3200	2500 x 1500	83	TTD5000	£POA

\*These models have remote power packs, without cover. POA = Price on application

### Double Horizontal Scissor Lifts

CAPACITY (kg)	FOLDED (mm)	STROKE (mm)	PLATFORM SIZE L x W (mm)	RISE TIME (secs)	ORDER REF	PRICE
2000	180	820	2600 x 800	30	TLH2000	£4761
2000	200	1300	4000 x 800	32	TAH2000	£7814
3000	230	1100	3400 x 900	35	TMH3000	£7406
4000	250	1500	4400 x 1200	55	TSH4000	£10818
6000	300	1700	5000 x 1300	53	TTH6000	£13177
8000	350	1500	4400 x 1200	53	TSH8000	£14649
10000	450	1500	5000 x 1300	75	TTH10000	£POA
10000	500	2000	6000 x 1500	72	TPH10000*	£POA

\*This model has remote power pack, without cover. POA = Price on application

### Double Vertical Scissors

- For greater lift height without increasing platform size
- These models must be securely bolted to the ground
- Popular models from stock

### Double Horizontal Scissors

- Two synchronised scissors
- Maximum stability for long, heavy loads



**BELLOWS AVAILABLE  
FOR ALL MODELS**



## Scissor Lifts

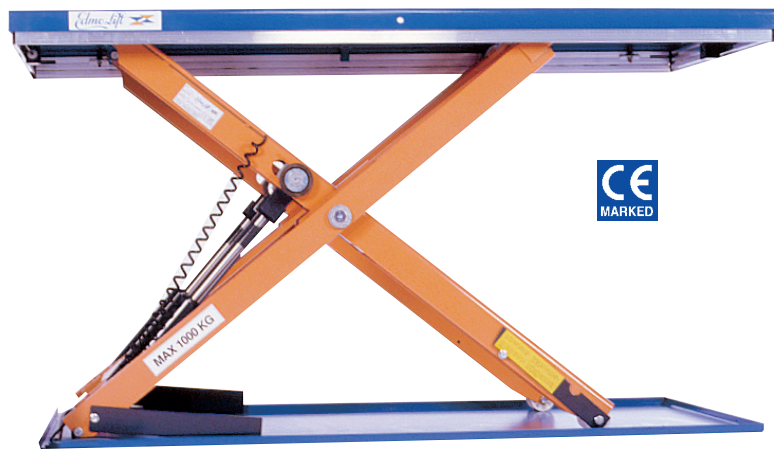

### Low Profile Scissor Lifts

- ✓ Patented lift mechanism allows a very low closed height, eliminating the need for a pit installation
- ✓ U- and E- shaped models are specifically designed to lift 2-way entry pallets straight from the pallet truck
- Easily relocatable within the workplace
- Convenient remote enclosed power/controls pack
- Special platform sizes quoted upon request
- Demonstration units are available

#### Low Profile Scissor Lift Tables

CAPACITY (kg)	FOLDED (mm)	STROKE (mm)	PLATFORM SIZE L x W (mm)	RISE TIME (secs)	ORDER REF	PRICE
500	80	630	900 x 600	9	TCR500	£2947
600	80	720	1500 x 900	13	TCB600	£3746
600	80	970	1500 x 900	19	TCB600H*	£3850
1000	80	820	1350 x 800	13	TCL1000	£4042
1000	80	820	1350 x 1000	13	TCL1000B	£4230
1000	80	820	1350 x 1270	13	TCL1000GB	£4755
2000	100	820	1350 x 800	24	TCL2000	£5108
2000	100	820	1350 x 1000	24	TCL2000B	£5214
2000	100	820	1350 x 1270	24	TCL2000GB	£5370

\*These models must be securely fixed to ground or floor



#### U- and E- Shaped Low Profile Scissor Lifts

STYLE	CAP (kg)	LOWEST HT (mm)	STROKE (mm)	PLATFORM EXT/INT L x W (mm)	RISE TIME	ORDER (secs)	PRICE REF
E-SHAPED	600	80	720	1450/1200 x 900/580	13	TUB600	£3911
E-SHAPED	600	80	970	1450/1200 x 900/580	19	TUB600H*	£4016
U-SHAPED	1000	80	820	1350/1145 x 1060/585	13	TUL1000	£4139
U-SHAPED	2000	100	820	1350/1145 x 1145/585	24	TUL2000	£5214

\*These models must be securely fixed to ground or floor

#### Ramps

RAMPS TO SUIT	DIMENSIONS LENGTH x WIDTH (mm)	ORDER REF	PRICE
TCR500	600 x 600	TCRR	£190.00
TCB600 & TCB600H	600 x 750	TCBR	£177.00
TCL1000	650 x 800	TCL1R	£205.00
TCL1000B & TCL1000GB	650 x 1000	TCL1B/GBR	£265.00
TCL2000 & TCL2000B	800 x 800	TCL2/BR	£250.00
TCL2000GB	800 x 1000	TCL2GBR	£279.00



## Lift & Tilt Armlifts

- ✓ Work positioners which lift the load and tilt to the required position. U-shaped models allow all types of pallet to be raised directly from the floor
- ✓ 1500kg capacity

- 750kg and 3000kg models are also available
- Suitable for use with 4-way entry pallets
- +5° to -40° tilt facility
- 16 secs rise time
- For use with conveyors, the back edge height (standard 229mm) can be manufactured to suit
- Armlifts must be securely fixed to the ground with expander bolts



750kg Capacity Armlift

#### Tilting Armlifts

STYLE	CAPACITY (kg)	LOWEST HT (mm)	STROKE (mm)	PLATFORM EXT/INT L x W (mm)	ORDER REF	PRICE
PLATFORM	1500	235	820	1300 x 800	ALT1500	£5497
U-SHAPED	1500	6	820	1380/1200 x 1310/850	ALT1500UE*	£6076
U-SHAPED	1500	6	820	1380/1200 x 1510/1050	ALT1500U*	£6001
U-SHAPED	1500	6	820	1380/1200 x 1710/1250	ALT1500GB*	£6271

\* These models have a remote power pack, with cover

ALT1500  
£5497





## System 25 Gravity Conveyor

- ✓ Track supplied fully assembled, simply bolt stand to track for finished item.
- ✓ Smooth, snag-free side frames
- Ideal for conveying cartons & tote bins
  - Spring loaded rollers, zinc plated
- Epoxy coated powder blue finish, 18-E-53
- Standard track lengths 1.5m and 3m
- Standard widths 300 / 450 / 600mm



### Adjustable Stands

Stands must be ordered separately as they are not included as standard

HEIGHT TO UNDERSIDE OF CONVEYOR (mm)	300/450 WIDE		600 WIDE	
	ORDER REF	PRICE	ORDER REF	PRICE
305-420	CSST345	£40.00	CSST390	£44.00
420-640	CSST445	£45.00	CSST490	£49.00
560-920	CSST545	£43.00	CSST590	£54.00
840-1040	CSST845	£52.00	CSST890	£57.00
1041-1240	CSST1045	£52.00	CSST1090	£61.00
1241-1440	CSST1245	£57.00	CSST1290	£65.00

### Designing Your Conveyor

#### ROLLER PITCH

The load must be in contact with at least 3 rollers at all times. Loads without a rigid base should be supported on a flat tray.

#### STANDS

The maximum distance between stands should not exceed 1500mm. Stands should also be positioned where tracks are joined.

#### GRADIENT

Where gravity movement is required the gradient should not exceed 1:25.

- ✓ 1.5m conveyor sections only are listed. 3m sections are readily available, at exactly twice the 1.5m price.

#### 35mm Dia Rollers Rated 25kg Per Roller

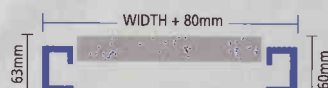

#### 38mm Dia Rollers Rated 30kg Per Roller

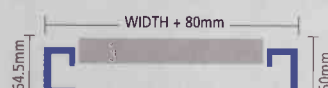

#### 50mm Dia Rollers Rated 45kg Per Roller

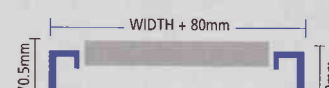

### 1.5m Long Roller Conveyors

ROLLER PITCH	CONVEYOR WIDTH			CONVEYOR WIDTH			CONVEYOR WIDTH		
	300mm	450mm	600mm	300mm	450mm	600mm	300mm	450mm	600mm
50mm	CS5025/300 £267.00	CS5025/450 £287.00	CS5025/600 £311.00	CS5030/300 £285.00	CS5030/450 £313.00	CS5030/600 £336.00	-	-	-
75mm	CS7525/300 £199.00	CS7525/450 £212.00	CS7525/600 £228.00	CS7530/300 £211.00	CS7530/450 £230.00	CS7530/600 £246.00	CS7545/300 £234.00	CS7545/450 £256.00	CS7545/600 £278.00
100mm	CS10025/300 £164.00	CS10025/450 £175.00	CS10025/600 £188.00	CS10030/300 £173.00	CS10030/450 £188.00	CS10030/600 £200.00	CS10045/300 £191.00	CS10045/450 £205.00	CS10045/600 £225.00
125mm	CS12525/300 £144.00	CS12525/450 £153.00	CS12525/600 £163.00	CS12530/300 £151.00	CS12530/450 £163.00	CS12530/600 £173.00	CS12545/300 £165.00	CS12545/450 £179.00	CS12545/600 £193.00
150mm	CS15025/300 £130.00	CS15025/450 £138.00	CS15025/600 £147.00	CS15030/300 £136.00	CS15030/450 £146.00	CS15030/600 £155.00	CS15045/300 £148.00	CS15045/450 £160.00	CS15045/600 £172.00

Above prices are for track only, see above table for stand prices

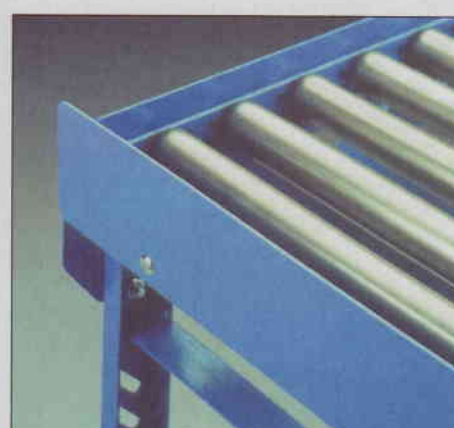

Please call us for a quotation on all these options: ✓ Ball Tables ✓ Hinged Gates ✓ Side Guides ✓ End Stops



## Folding Workshop Cranes



SC1000  
£508

WARRIOR

## Folding Workshop Crane

✓ Self standing and completely mobile when in the folded position

- 1000kg or 2000kg maximum capacities
  - 3 position telescopic jib
- 1000kg model: 700/800/1000kg positions
- 2000kg model: 1500/1700/2000kg positions
  - Double acting pump unit
- Heavy duty swivel hook with safety catch
- Pressure relief valve to prevent overloading

**12** month  
PARTS & LABOUR  
WARRANTY

**Folds for  
compact storage!**

MAXIMUM CAPACITY (kg)	OVERALL SIZE L x W (mm)	HOOK HEIGHT (mm)	ORDER REF	PRICE
1000	1630 x 1120	FLOOR - 2445	SC1000	£508.00
2000	1900 x 1165	FLOOR - 2705	SC2000	£699.00



**RAPID  
DELIVERY**



## Folding Workshop Cranes

✓ Highly manoeuvrable and folds flat for easy storage

- Capacity 500kg and 1000kg
- Folds down to small footprint for storage
  - 4 x hook positions (1000kg version)
    - Twin braked wheels
- Bearings in all castors - smoother running
  - Dual acting pump - quick lift
  - Progressive, slow lowering



CR500JCB  
£316

**Folds for  
compact storage!**



CAPACITY (KG)	RAISED HEIGHT (MM)	CLOSED HEIGHT (MM)	JIB REACH (MM)	OVERALL LENGTH (MM)	WIDTH BETWEEN LEGS (MM)	ORDER REF	PRICE
500	1380	340	910	1600	790	CR500JCB	£316.00
1000	1770	430	770	1830	890	CR1000JCB	£359.00



## Steerman Load Moving Skates

- Designed and engineered in Britain for the safe transport of loads up to 100 tonnes
- Moves heavy loads easily across factory floors
- Load is spread over multiple rollers ensuring no surface damage
- Extra modules may be added for extra large, heavy or awkward loads
- Independent rear trolleys are supplied in pairs with adjustable linking bars



Quality products  
British made with  
long life in mind

CAPACITY PER SET (kg)	HEIGHT (mm)	NUMBER OF ROLLERS	WIDTH ADJUSTMENT (mm)	WEIGHT (kg)	ORDER REF	PRICE
10000	102	16 BLACK	252 - 1200	54	SX10	£748.00
15000	102	32 BLUE	480 - 1500	76	SX15	£1044.00
20000	102	32 BLACK	480 - 1500	76	SX20	£1341.00
25000	110	48 BLUE	720 - 1500	136	SX25	£1425.00
30000	110	48 BLACK	720 - 1500	136	SX30	£1582.00



## 'LX' Load Moving Skates

This new range of load moving systems are now available as a 'low cost' alternative to our premium Steerman range of skates



**RAPID DELIVERY**  
ON SELECTED ITEMS



CAPACITY (kg)	HEIGHT (mm)	NET WEIGHT (kg)	ORDER REF	PRICE
6000	115	45	LX-6	£272.00
12000	115	96	LX-12	£428.00

CAPACITY (kg)	HEIGHT (mm)	NET WEIGHT (kg)	ORDER REF	PRICE
20000	62	50	SCS-20	£394.00
30000	74	58	SCS-30	£489.00
60000	92	92	SCS-60	£683.00

## Hydraulic Jacks



### Bottle Jacks

- ✓ 2 to 30 tonnes capacity

- High force for general operation
- Lift, push, move & support loads
  - Robust long life design
  - Safety overload valve



### Aluminum Jacks

- ✓ 6.5 to 100 tonnes capacity

- Low weight - high lift capacity
- High tensile aluminium alloy
- Hardened alloy steel saddle
- Also available with claws



★ **BEST SELLERS** ★

### Machine Toe Jacks

- ✓ 3 to 10 tonnes capacity

- Same load on head & claw
- Very low clearance on claw
  - Large stable base
  - Safety overload valve

JACK TYPE	CAPACITY ON HEAD (kg)	CLOSED HEIGHT (mm)	STROKE (mm)	EXTRA SCREW ADJUSTMENT (mm)	BASEPLATE (mm)	WEIGHT (kg)	ORDER REF	PRICE
UNIVERSAL BOTTLE JACKS	2000	181	115	50	90 x 95	2.7	JH-2	£44.00
	4000	205	126	60	115 x 110	3.7	JH-4	£47.00
	6000	219	130	75	115 x 110	4.7	JH-6	£54.00
	8000	225	152	70	120 x 120	5.7	JH-8	£66.00
	12000	240	153	80	140 x 130	8.0	JH-12	£79.00
	20000	240	153	80	160 x 155	11.0	JH-20	£112.00
	30000	280	180	-	210 x 180	22.0	JH-30	£251.00
ALUMINIUM JACKS	6500	131	75	-	159 x 76	3.6	AJS-653	£347.00
	10000	182	115	-	171 x 76	6.3	AJH-104	£527.00
	20000	265	152	-	180 x 120	10.9	AJH-620	£615.00
	20000	440	305	-	250 x 120	16.7	AJH-1220	£818.00
	30000	265	152	-	200 x 140	15.4	AJH-630	£697.00
	30000	452	305	-	275 x 140	23.4	AJH-1230	£1056.00
	60000	293	152	-	250 x 190	27.4	AJH-660	£1088.00
	60000	500	305	-	340 x 190	43.7	AJH-1260	£1329.00
	100000	315	152	-	305 x 250	49.0	AJH-6100	£1982.00
MACHINE JACKS WITH LIFTING CLAW	3000	230	130	-	151 x 110	16.4	HTJ-3	£242.00
	6000	268	152	-	280 x 190	23.2	HTJ-6	£328.00
	10000	280	130	-	295 x 230	38.2	HTJ-10	£409.00

## Lifting Gear



★ BEST ★  
SELLERS

### '92 Series' Standard Vertical Plate Clamps

These clamps are primarily used for transporting sheet metal and steel plates in the vertical position, as well as lifting and rotating through 180°

CAP (kg)	JAW CAPACITY (mm)	ORDER REF	PRICE
500	0 - 16	92.500	£152.00
1500	0 - 20	92.1500	£174.00
2000	0 - 32	92.2000	£218.00
3000	0 - 32	92.3000	£311.00



### 'CY' Hinged Vertical Plate Clamps

These clamps have been designed for lifting and handling of longer plates when used in pairs with a two legged chain sling thus eliminating the need for a spreader beam

CAP (kg)	JAW CAPACITY (mm)	ORDER REF	PRICE
1000	0 - 20	CY1	£241.00
2000	0 - 32	CY2	£320.00
3000	0 - 32	CY3	£344.00



Quality products  
British made with  
long life in mind



### 'CH' Standard Horizontal Plate Clamps

These clamps have been specifically designed to be used in pairs, for the transportation of plate bundles as well as single plates with a minimum thickness of 5mm. 2 supplied

CAP / PAIR (kg)	JAW CAPACITY (mm)	ORDER REF	PRICE PAIR
1000	5 - 32	CH1	£178.00
2000	5 - 32	CH2	£213.00
4000	5 - 50	CH4	£272.00
6000	5 - 75	CH6	£350.00



★ NEW ★  
PRODUCT

### CPV Electric Chain Hoist, with suspension lug or integrated travel trolley

- ✓ Combines modern design and technical innovation
- ✓ A robust construction makes the series a versatile tool for industrial applications. Upper and lower limit switches considerably extend the working life span of the slip clutch, motor and gearbox
- Capacities 125kgs - 2000kgs
- Available with lug or hook suspension, or fitted with a range of push, geared and electric trolleys
- Single or Dual Speed Motors
  - Designed to FEM 1Am
- 2 year warranty (excluding wearing parts) and a life time lubricated gearbox

**2** years  
GUARANTEE

**RAPID**  
DELIVERY  
ON SELECTED ITEMS

FROM  
£753

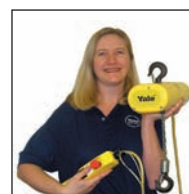

ONLY  
WEIGHS  
12kgs

CAPACITY (kgs)	LIFT SPEED (mtrs/min)	HOOK SUSPENSION		PUSH TRAVEL TROLLEY		GEARED TRAVEL TROLLEY		SINGLE SPEED ELECTRIC TROLLEY	
		REF	PRICE	REF	PRICE	REF	PRICE	REF	PRICE
125	8	V125/1S	£783.00	V125/1SP	£856.00	V125/1SG	£928.00	V125/1SE	£1314.00
125	DUAL: 8 / 2	V125/1D	£870.00	V125/1DP	£946.00	V125/1DG	£1021.00	V125/1DE	£1418.00
250	8	V250/1S	£856.00	V250/1SP	£928.00	V250/1SG	£1001.00	V250/1SE	£1386.00
250	DUAL: 8 : 2	V250/1D	£944.00	V250/1DP	£1021.00	V250/1DG	£1095.00	V250/1DE	£1494.00
500	4	V500/2S	£966.00	V500/2SP	£1067.00	V500/2SG	£1138.00	V500/2SE	£1525.00
500	DUAL: 4 / 1	V500/2D	£1058.00	V500/2DP	£1164.00	V500/2DG	£1239.00	V500/2DE	£1636.00
1000	8	V1000/1S	£1240.00	V1000/1SP	£1336.00	V1000/1SG	£1416.00	V1000/1SE	£1796.00
1000	DUAL: 8 / 2	V1000/1D	£1357.00	V1000/1DP	£1452.00	V1000/1DG	£1531.00	V1000/1DE	£1912.00
2000	4	V2000/2S	£1643.00	V2000/2SP	£1812.00	V2000/2SG	£1898.00	V2000/2SE	£2286.00
2000	DUAL: 4 / 1	V2000/2D	£1818.00	V2000/2DP	£1987.00	V2000/2DG	£2072.00	V2000/2DE	£2459.00

### CPS Electric Chain Hoist

- ✓ The CPS electric chain hoist lifts loads upto 125kgs - yet weighs only 12kgs
- Available in 110, 230 & 400volt options

POWER SUPPLY	LIFT SPEED (mtr/min)	ORDER REF	PRICE
110v 1-phase	4	CPS1/4	£753.00
230v 1-phase	4	CPS2/4	£753.00
400v 3-phase	4	CPS4/4	£753.00
400v 3-phase	10	CPS4/10	£753.00

Extra lift REF EL125 PRICE £16.00 per metre





## Lifting Gear

FROM  
£120

## 'CTP' Integral Trolley Clamp

- Very quick and easy installation
- Safety is ensured by a special locking lever

CAPACITY (kg)	BEAM WIDTH (mm)	ORDER REF	PRICE
1000	60 - 150	CTP1A	£120.00
2000	75 - 200	CTP2A	£160.00
2000	200 - 300	CTP2B	£170.00
3000	75 - 200	CTP3A	£204.00
3000	200 - 300	CTP3B	£223.00

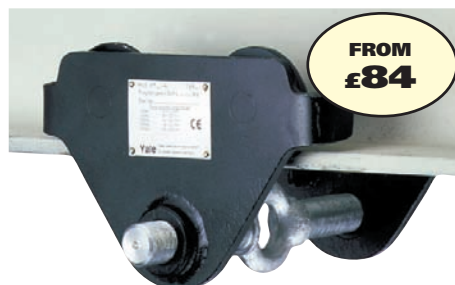
FROM  
£84

## 'HTP' Push Beam Trolleys

- Robust lightweight construction
- Precision ball bearing mechanism

CAPACITY (kg)	BEAM WIDTH (mm)	ORDER REF	PRICE
500	50 - 220	HTP5	£84.00
1000	58 - 220	HTP1	£110.00
2000	66 - 220	HTP2	£141.00
3000	74 - 220	HTP3	£226.00
5000	90 - 220	HTP5	£335.00

FROM  
£141

## 'HTG' Geared Beam Trolleys

- Enables exact positioning or traversing
- Adjustable to fit wide range of beam widths

CAPACITY (kg)	BEAM WIDTH (mm)	ORDER REF	PRICE
500	50 - 220	HTG5	£141.00
1000	58 - 220	HTG1	£165.00
2000	66 - 220	HTG2	£198.00
3000	74 - 220	HTG3	£257.00
5000	90 - 220	HTG5	£346.00

FROM  
£69

## 'YC' Beam Clamp

- Provides quick and easy rigging point
- Flexible application due to wide adjustment

CAPACITY (kg)	BEAM WIDTH (mm)	ORDER REF	PRICE
1000	75 - 230	YC1	£69.00
2000	75 - 230	YC2	£75.00
3000	80 - 320	YC3	£93.00
5000	90 - 320	YC5	£105.00
10000	90 - 320	YC10	£156.00

FROM  
£160

## Permanent Lifting Magnet

- Lightweight and very easy to use
- Unlimited applications

CAPACITY (kg)	PLATE L x W (mm)	ORDER REF	PRICE
100	122 - 69	TPM1	£160.00
300	192 - 95	TPM3	£366.00
500	232 - 120	TPM5	£481.00
800	302 - 154	TPM8	£746.00
1000	332 - 154	TPM10	£908.00

FROM  
£118★ BEST ★  
SELLER

## 'Handy' Ratchet lever Hoists

- Compact and lightweight unit, only 2.2kgs
- 1.5m lifting height as standard

CAPACITY (kg)	HOIST WITH 1.5M LIFT		EXTRA METRE LIFT	
	REF	PRICE	REF	PRICE
250	HANDY250	£75.00	HANDY250X	£28.00
500	HANDY500	£96.00	HANDY500X	£28.00



## 'UNO' Ratchet Lever Hoists

- For pulling, lifting and lashing of loads
- 1.5m lifting height as standard

CAPACITY (kg)	HOIST WITH 3M LIFT		EXTRA METRE LIFT	
	REF	PRICE	REF	PRICE
750	UNO.75	£119.00	UNO.75X	£30.00
1500	UNO1.5	£136.00	UNO1.5X	£33.10
3000	UNO3	£169.00	UNO3X	£39.20
6000	UNO6	£241.00	UNO6X	£59.70

This is just a selection of what we can offer. A wider range of lifting gear is available, please call us for more details

**RAPID DELIVERY**  
ON SELECTED ITEMS

BUDGET CHOICE!

## 'VSplus' Hand Chain Hoist

- Extremely robust all-steel construction
- 3m lifting height as standard

CAPACITY (kg)	HOIST WITH 3M LIFT		EXTRA METRE LIFT	
	REF	PRICE	REF	PRICE
500	VSPLUS0.5	£118.00	VSPLUS0.5X	£17.60
1000	VSPLUS1.0	£126.00	VSPLUS1.0X	£17.60
2000	VSPLUS2.0	£168.00	VSPLUS2.0X	£26.90
3000	VSPLUS3.0	£241.00	VSPLUS3.0X	£32.00
5000	VSPLUS5.0	£315.00	VSPLUS5.0X	£42.00



## Gas Cylinder Handling

### Gas Cylinder Trucks ✓ Ergonomic designs ✓ Precision welded steelwork

- Quality epoxy powder coated finish
- Free draining punched toe plates
- Galvanised chains retain cylinders in position
- Quiet running rubber tyred wheels
- Unique rear wheel support attachments may be fitted by the user at any time



#### Double Cylinder Trucks OXY-ACETYLENE & OXY-PROPANE



#### OXY-ACETYLENE TRUCKS (240/290 max cylinder dia)

- 1050H x 760W x 520Dmm
- 300mm wheels
- Weight 17kg
- 2-Wheel O-A Truck  
**REF OACT PRICE £156.00**
- O-A Truck with Rear Wheels\*  
**REF OACT/RW PRICE £247.00**

#### OXY-PROPANE TRUCKS (240/410 max cylinder dia)

- 1050H x 880W x 520Dmm
- 300mm wheels
- Weight 18kg
- 2-Wheel O-P Truck  
**REF OPCT PRICE £169.00**
- O-P Truck with Rear Wheels\*  
**REF OPCT/RW PRICE £259.00**

\* Rear wheel models are 900mm deep, and weigh 5kg more

#### Rear Wheel Attachment Kit

- Suits both Oxy-Acetylene and Oxy-Propane 2-wheel trucks
- Bolt-on frame with 100mm rubber tyred castors

**REF RW/OA/OP PRICE £90.00**



### Single Cylinder Trucks

#### UNIVERSAL 280 TRUCKS

- Suits all cylinders up to 280mm diameter
- 1050H x 483W x 520Dmm
- 200mm wheels
- Weight 10kg

#### 2-Wheel Truck

**REF SCT/280 PRICE £95.00**

#### Truck with Rear Wheel

**REF SCT/280/RW PRICE £163.00**

#### PROPANE TRUCKS

- For 47kg Propane and similar cylinders
- 1050H x 583W x 520Dmm
- 200mm wheels
- Weight 11kg

#### 2-Wheel Truck

**REF PT/47 PRICE £95.00**

#### Truck with Rear Wheel

**REF PT/47/RW PRICE £162.00**

#### Rear Wheel Attachment Kit

- Suits both Universal 280 and Propane 2-wheel trucks
- Bolt-on frame with 100mm rubber tyred castor

**REF RW/PT/SCT PRICE £68.00**

### Cylinder Holders



#### Wall Brackets

- Tubular design
- Epoxy coated steelwork
- Bright zinc plated chains
- For cylinders up to 280 dia

#### 2-Cylinder Bracket 650mm long

**REF CWB/2W PRICE £45.00**

#### 3-Cylinder Bracket 965mm long

**REF CWB/3W PRICE £54.00**



#### Cylinder Stand

- For all cylinders up to 280mm dia
- Solid steel baseplate
- Locking access bars
- Epoxy coated steelwork

#### Cylinder Stand

600H x 340W x 310Dmm

**REF CS/280 PRICE £98.00**



## Gas Cylinder Trolleys

✓ Designed for the handling and transportation of gas cylinders

- 50-150kg capacities
- Fully welded tubular steel construction
- Powder coated blue finish, RAL 5007
- Support chain for securing bottles
- Solid rubber or pneumatic tyred models
- Models 51021 and 51022 fitted with supporting castor



51022  
£353

**5** years  
QUALITY  
GUARANTEE

All items on  
this page



51005  
£143



51007  
£237



51012  
£271



51032  
£362

CAPACITY (kg)	HEIGHT (mm)	TOTAL WIDTH (mm)	NO. BOTTLES SIZE (Litres / kg)	SOLID RUBBER TYRES (mm)	PNEUMATIC TYRES (mm)	WEIGHT (kg)	ORDER REF	PRICE
50	1000	505	2 x 10	200 x 50	-	7	51005	£143.00
100	1100	760	2 x 20	250 x 60	-	17.5	51006	£237.00
100	1100	760	2 x 20	-	260 x 85	15	51007	£237.00
150	1300	830	2 x 40-50	400 x 80	-	33	51011	£288.00
150	1300	830	2 x 40-50	-	400 x 100	23	51012	£271.00
150	1300	830	2 x 40-50	400 x 80	-	38	51021	£368.00
150	1300	830	2 x 40-50	-	400 x 100	28	51022	£353.00
150	1300	925	1 x 50, 1 x 33	400 x 80	-	35	51031	£378.00
150	1300	925	1 x 50, 1 x 33	-	400 x 100	25	51032	£362.00
150	1300	1020	2 x 33	400 x 80	-	38	51041	£460.00
150	1300	1020	2 x 33	-	400 x 100	28	51042	£443.00

## Cylinder Holders

### Cylinder Stand

- Stand for 2 bottles, each 40-50 litre contents, 204-229mm diameter
- Steel section/sheet steel design
- Powder coated blue finish (RAL 5007)
- Pre-drilled for connecting or for wall fixing
- Secured with chain

REF 51150  
PRICE £154.00



51150  
£154

### Wall Brackets

- Wall mounting for 1-3 steel bottles, bottle diameter 140, 230 and 320mm
- Steel sheet construction, pre-drilled u-shaped rail for wall fixing
- 1-3 bottle clamps • Secured with chain
- Hot dip galvanised

NO. BOTTLES	BOTTLE DIA (mm)	ORDER REF	PRICE
1	140	51114	£32.00
1	230	51123	£39.00
1	320	51132	£44.00
2	140	51214	£48.00
2	230	51223	£63.00
2	320	51232	£78.00
3	140	51314	£71.00
3	230	51323	£87.00
3	320	51332	£118.00





## Drum Handling

### Drum Trucks ✓ A modern design of truck with optional load support wheels

- Designed for 210 litre steel drums
- Rear wheel attachment can be added at any time
- Epoxy powder coated finish



DT/RW  
**£265**

2-Wheel Drum Truck  
REF DT/1 PRICE £195.00

Drum Truck with Rear Wheels  
With 80mm rubber load castors  
REF DT/RW PRICE £265.00

Rear Wheel Attachment Kit  
for 2-wheel model  
REF RW/DT PRICE £77.00



DT/1  
**£195**

#### SPECIFICATION

- Capacity 270kg
- Weight 21kg
- 1520L x 620W x 420Hmm
- 250mm rubber tyred wheels

### Universal Drum Transporter & Stand

✓ A complete one man drum handling system

✓ Safely lifts, transports and rotates 210 litre steel drums ready for dispensing

- Operator need not touch drum when loading
- Detachable handle has two mounting points, one for raising and lowering the drum and one for transporting it
  - Positive and secure drum locking hook
- Top rollers for drum rotation
- Epoxy powder coated finish



UDT  
**£295**

*It lifts...  
It transports...  
It rotates the drum!*



#### SPECIFICATION

- Capacity 250kg
- Weight 17kg
- 800L x 620W x 540Hmm
- Height to lower rim when horizontal 387mm
- 200mm fixed rubber tyred wheels
- 80mm nylon swivel castors

REF UDT PRICE £295.00

### Drum Dollies

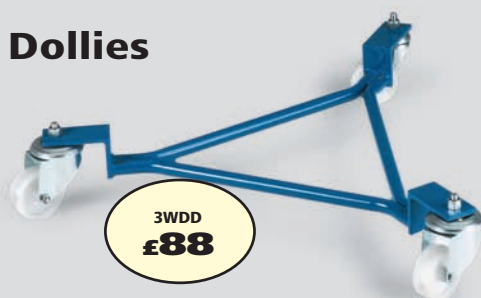

3WDD  
**£88**

#### 3 Wheel Drum Dolly

✓ Can be loaded or unloaded by drum truck DT/1

- Suitable for 210 litre steel drums
- Capacity 250kg
- Weight 8kg
- 735mm diameter x 125mm height
- 75mm nylon swivel castors

REF 3WDD PRICE £88.00



4WDD  
**£109**

#### 4 Wheel Drum Dolly

✓ Design allows loading by overhead lift

- Suitable for 210 litre steel drums
- Capacity 250kg
- Weight 13kg
- 742mm diameter x 160mm height
- 75mm nylon swivel castors

REF 4WDD PRICE £109.00



## Steel Drum Trolleys

✓ Suitable for all rimmed 200 litre drums

- Robust welded tubular steel construction
- Durable blue powder coated finish
- Solid rubber or pneumatic tyres
- Support wheels are fitted to some models for stability



1065  
£239



1071  
£255

**5** years  
QUALITY  
GUARANTEE



2078  
£311



2080  
£227



## Plastic Drum Trolley

✓ Designed for 120-220 litre plastic drums

- Welded tubular steel construction with durable powder coated finish
- Solid rubber or pneumatic tyres
- Tension belt safely secures drums
- Trolley can be rested horizontally to allow easy drum dispensing

DRUM TYPE	CAPACITY (kg)	HEIGHT (mm)	TOTAL WIDTH (mm)	SOLID RUBBER TYRES (mm)	PNEUMATIC TYRES (mm)	WEIGHT (kg)	ORDER REF	PRICE
STEEL	300	1600	680	250 x 60	-	17.5	1065	£239.00
STEEL	300	1600	680	-	260 x 85	15	1066	£239.00
STEEL	300	1600	680	250 x 60	-	23.5	1071	£255.00
STEEL	300	1600	680	-	260 x 85	21	1072	£255.00
STEEL	300	1600	680	250 x 60	-	24.5	2078	£311.00
STEEL	300	1600	680	-	260 x 85	22	2079	£311.00
PLASTIC	250	1300	640	250 x 60	-	20.5	2080	£227.00
PLASTIC	250	1300	640	-	260 x 85	18	2081	£227.00



## Drum Handling

### Drum Caddy

- Drum caddy will handle 140/210 litre steel & plastic drums
- Removable handle is used to tilt drums for positioning and doubles up as a bung key
  - Capacity 500kg
- Overall size 950H x 750W x 570Dmm
  - Weight 17kg

REF DC500 PRICE £248.00



Tilt handle also acts as drum key

★ NEW ★  
PRODUCTS

DC500  
£248



### Drum Porter Plus

- Will handle 210 litre drums on and off bund pallets as well as regular pallets
  - Capacity 450kg
- Drum lift 500mm • Lift per stroke 12mm
  - Max drum size 915L x 572 dia
  - Dimensions 900L x 1020Wmm
- Max height in lowered position 1250mm
- Max height in raised position 1380mm
  - Weight 165kg

REF DTF450 PRICE £948.00



DTF450  
£948



**12** month  
PARTS &  
LABOUR  
WARRANTY



DT250  
£395



DTW250  
£446



DTR250  
£495

**RAPID  
DELIVERY**

### Drum Porter

- Easy to use it lifts the drum hydraulically off the floor for transportation and smoothly lowers it via a spring return knob
  - Capacity 250kg
  - Max drum size 915L x 572 dia
- Drum lift 345mm • Lift per stroke 22mm
  - Dimensions 1000H x 780W x 810Lmm
  - Weight 40kg

REF DT250 PRICE £395.00

### Wide Straddle Drum Porter

- Enables lifting of 210 litre drums off 800mm wide Europallets
  - Fitted with parking brake
- Capacity 250kg • Max drum dia 572mm
- Drum lift 345mm • Lift per stroke 22mm
  - Inside straddle 850mm
  - Outside O/A straddle 1015mm

REF DTW250 PRICE £446.00

### Override Drum Porter

- Wide straddle & cantilever frame to pass over Europallets (800mm max width)
  - Also allows drums to be lifted from corners of spillage containment units
- Capacity 250kg • Max drum dia 572mm
  - Max drum height 1180mm
  - Min drum height 910mm
  - Inside straddle 850mm
  - Outside O/A straddle 980mm

REF DTR250 PRICE £495.00



## Drum Lifter

- ✓ Provides a simple yet highly effective safe handling solution for rapid transfer of steel drums

- Secured to forks by zinc plated thumb screws
- Minimum moving parts for low maintenance
- Polyester powder coated in bright orange for safety
- Fully automatic with no intervention from forklift driver

CAPACITY (kg)	No OF DRUMS	MAX FORK SIZE (mm)	FORK CENTRES (mm)	ORDER REF	PRICE
500	1	125 x 50	408	IDL-1	£475.00
1000	2	125 x 50	408	IDL-2	£595.00



## Rim Grip Drum Handler

- ✓ This versatile and efficient attachment allows automatic and safe handling of steel and plastic ring drums.
- ✓ Can handle drums of varying diameters as well as damaged or open top drums.
  - Forged and hardened steel jaw grip
  - Secured safely to forks with zinc plated thumb screws
  - Polyester powder coated in bright orange for safety
  - Fully automatic with no intervention from forklift driver

CAPACITY (kg)	No OF DRUMS	MAX FORK SIZE (mm)	FORK CENTRES (mm)	ORDER REF	PRICE
750	1	125 x 50	412	IRG-1	£933.00
1500	2	125 x 50	412	IRG-2	£1209.00



## Drum Tilter

- ✓ Designed for controlled and effortless pouring of contents of steel drums.
- ✓ Fitted with worm gear box which features full 360 degrees rotation and unique locking facility enabling drums to be held at an angle.
  - Robust gearbox complete with torque limiter
- Safely secured to forks with zinc plated thumb screws
- Polyester powder coated in bright orange for safety
- Zinc plated fork heel pins for safe attachment to truck

TILT MECHANISM	CAPACITY (kg)	MAX FORK SIZE (mm)	FORK CENTRES (mm)	ORDER REF	PRICE
HAND WHEEL	360	150 x 50	869	IDTL-1	£918.00
LOOPED CHAIN	360	150 x 50	869	IDTL-2	£1108.00



## Crane Slung Drum Tilter

- ✓ An Ideal alternative for the movement and controlled pouring of contents of steel drums.
- ✓ Ideally used where a fork lift truck is inaccessible and an overhead crane is available.
  - Robust gearbox complete with torque limiter
  - Lifting eye suitable for hook attachment
- Polyester powder coated in bright orange for safety
- Hand wheel and looped chain models available

TILT MECHANISM	CAPACITY (kg)	ORDER REF	PRICE
HAND WHEEL	360	ICTL-1	£918.00
LOOPED CHAIN	360	ICTL-2	£1108.00



## Modular Trolleys

### Modular Trolleys ✓ Can be altered, interchanged and supplemented in many ways

- Complies with Euronorm 1757-3 for enhanced operator safety
- Capacity up to 500kg
- Tubular and angle welded steel
- Finish resists impact and scratches
- Decked in beech veneered heavy duty particle board
- 2 castor and 2 fixed wheels
- Cushion rubber tyres
- 5 year quality guarantee



FROM  
£217

### MultiVario System

A newly designed technology to make your transport trolley program not only more powerful, effective and attractive - but magic. There are no more bulging or protruding "corner pillars" and no more rough welding seams. Furthermore, the frame profile height has been increased to provide even more stability. This does not simply lead to a functional improvement but at the same time it virtually creates a perfectly shaped new look for the MultiVario transport trolleys. German Patent 39 17 279

**RAPID  
DELIVERY**

**5 years**  
**QUALITY  
GUARANTEE**

Multivario  
accessories -  
see page 136



Quality powder  
coat finish on shot  
blasted steelwork

### Panelled End Trolleys

OVERALL DIMENSIONS H x L x W (mm)	PLATFORM SIZE L x W (mm)	CAPACITY (kg)	WEIGHT (kg)	WHEEL DIAMETER (mm)	ORDER REF	PRICE
950 x 970 x 500	850 x 500	400	26	160	2510	£217.00
990 x 1120 x 600	1000 x 600	500	33	200	2511	£228.00
990 x 1120 x 700	1000 x 700	500	36	200	2512	£232.00
990 x 1320 x 800	1200 x 800	500	42	200	2513	£250.00





SOME ITEMS ON THIS  
PAGE WILL BE SUPPLIED  
IN KD FORM



2592  
**£175**

### Platform

Overall length as table below -60mm  
Overall height as table below -720mm



2500  
**£192**

### One Open End



**MultiVario  
System**



2562  
**£355**

### Box Cart

Overall length as table below + 60mm

### Platform & Single End Trolleys

OVERALL DIMENSIONS H x L x W (mm)	PLATFORM SIZE L x W (mm)	CAPACITY (kg)	WHEEL DIAMETER (mm)	PLATFORM		OPEN END		BOX CART	
				REF	PRICE	REF	PRICE	REF	PRICE
950 x 970 x 500	850 x 500	400	160	2590	£163.00	2500	£192.00	2560	£323.00
990 x 1120 x 600	1000 x 600	500	200	2591	£173.00	2501	£204.00	2561	£352.00
990 x 1120 x 700	1000 x 700	500	200	2592	£175.00	2502	£206.00	2562	£355.00
990 x 1320 x 900	1200 x 800	500	200	2593	£191.00	2503	£228.00	2563	£380.00



2522  
**£289**

### Double End Trolley



2532  
**£326**

### 3 Sided Trolley



2552  
**£364**

### Box Cart

### Multi-Sided Trolleys

OVERALL DIMENSIONS H x L x W (mm)	PLATFORM SIZE L x W (mm)	CAPACITY (kg)	WHEEL DIAMETER (mm)	DOUBLE END		3 SIDED		BOX CART	
				REF	PRICE	REF	PRICE	REF	PRICE
950 x 1030 x 500	850 x 500	400	160	2520	£271.00	2530	£307.00	2550	£341.00
990 x 1180 x 600	1000 x 600	500	200	2521	£283.00	2531	£321.00	2551	£355.00
990 x 1180 x 700	1000 x 700	500	200	2522	£289.00	2532	£326.00	2552	£364.00
990 x 1320 x 800	1200 x 800	500	200	2523	£310.00	2533	£349.00	2553	£391.00



2582  
**£209**

### Stanchioned Trolley

Overall length as table below + 160mm



2542  
**£341**

### Panelled Bale Trolley



2572  
**£320**

### Tubular Bale Trolley

### Special Purpose Trolleys

OVERALL DIMENSIONS H x L x W (mm)	PLATFORM SIZE L x W (mm)	CAPACITY (kg)	WHEEL DIAMETER (mm)	STANCHIONED		PANELLED BALE		TUBULAR BALE	
				REF	PRICE	REF	PRICE	REF	PRICE
950 x 910 x 500	850 x 500	400	160	2580	£196.00	-	-	-	-
1025 x 1060 x 600	1000 x 600	500	200	2581	£206.00	2541	£339.00	2571	£318.00
1025 x 1060 x 700	1000 x 700	500	200	2582	£209.00	2542	£341.00	2572	£320.00
1025 x 1260 x 800	1200 x 800	500	200	2583	£225.00	2543	£364.00	2573	£349.00



## Modular Trolleys



**MultiVario  
System**



**RAPID  
DELIVERY**



**5 years  
QUALITY  
GUARANTEE**

### One Mesh End



### Side Frame Trolley



### Platform Trolleys with One Mesh End

OVERALL DIMENSIONS H x L x W (mm)	PLATFORM SIZE L x W (mm)	CAPACITY (kg)	WEIGHT (kg)	WHEEL DIAMETER (mm)	ORDER REF	PRICE
950 x 970 x 500	850 x 500	400	26	160	1510	£209.00
990 x 1120 x 600	1000 x 600	500	34	200	1511	£219.00
990 x 1120 x 700	1000 x 700	500	37	200	1512	£225.00
990 x 1320 x 900	1200 x 800	500	43	200	1513	£241.00

### Side Frame Trolleys

OVERALL DIMENSIONS H x L x W (mm)	PLATFORM SIZE L x W (mm)	CAPACITY (kg)	WEIGHT (kg)	WHEEL DIAMETER (mm)	ORDER REF	PRICE
985 x 910 x 500	850 x 500	400	29	160	1580SF	£259.00
1025 x 1060 x 600	1000 x 600	500	35	200	1581SF	£269.00
1025 x 1060 x 700	1000 x 700	500	40	200	1582SF	£271.00
1025 x 1260 x 800	1200 x 800	500	44	200	1583SF	£288.00

### Double End Mesh Trolley



### 3 Sided Mesh Trolley



### Mesh Box Cart



### Mesh Trolleys

OVERALL DIMENSIONS H x L x W (mm)	PLATFORM SIZE L x W (mm)	CAPACITY (kg)	WHEEL DIAMETER (mm)	DOUBLE END MESH		SIDED MESH		MESH BOX CART	
				REF	PRICE	REF	PRICE	REF	PRICE
950 x 1030 x 500	850 x 500	400	160	1520	£254.00	1530	£298.00	1550	£340.00
990 x 1180 x 600	1000 x 600	500	200	1521	£267.00	1531	£314.00	1551	£360.00
990 x 1180 x 700	1000 x 700	500	200	1522	£274.00	1532	£317.00	1552	£362.00
990 x 1380 x 800	1200 x 800	500	200	1523	£292.00	1533	£342.00	1553	£391.00

## Accessories & Optional Fittings for Modular Trolleys



**Blue/Grey Solid Trackless  
Tyres (set of 4)**  
Factory fitted

160mm diameter  
**REF 2186**  
**PRICE £30.50** extra/set  
200mm diameter  
**REF 2187**  
**PRICE £42.00** extra/set



**Pneumatic Tyres**  
400kg max capacity  
Factory fitted

220mm diameter  
**REF 1100**  
**PRICE £130.00** extra/set  
(not suitable for 160mm  
diameter wheels)



**Steel Platform**  
(zinc plated sheet  
over standard deck)  
850x500 or 1000x600  
(please specify size)  
**REF 1280 PRICE £63.00**  
1000x700 or 1200x800  
(please specify size)  
**REF 1281 PRICE £76.00**



**Wire Basket**  
For smaller items,  
powder coated  
aluminium finish.  
600L x 140W x 200Hmm  
**REF 1291**  
**PRICE £44.10\***

\*Carriage is extra if items are  
sent separately from trolley



**Clipboard A4**  
Wood, with paper  
clamp and pencil  
holder.  
**REF 12.90**  
**PRICE £33.60\***





**MultiVario  
System**

## Heavy Duty 1200kg Modular Trolleys

✓ Tubular welded steel construction with anti-slip waterproof platform and ends

✓ Complies with EuroNorm 1757-3

- Powder coated finish RAL blue 5007
- 2 fixed & 2 swivel roller bearing wheels
- High quality 200 x 50mm cushion rubber tyred wheels



**RAPID  
DELIVERY**

**5** years  
**QUALITY  
GUARANTEE**

**SUPPLIED IN KD FORM**



PIC	MODEL DESCRIPTION	OVERALL DIMENSIONS L x W x H (mm)	PLATFORM SIZE L x W (mm)	CAPACITY (kg)	WEIGHT (kg)	ORDER REF	PRICE
<b>A</b>	OPEN END PLATFORM TROLLEYS	1150 x 700 x 1000	1000 x 700	1200	35	12502	£375.00
		1350 x 800 x 1000	1200 x 800	1200	48	12503	£410.00
		1750 x 800 x 1000	1600 x 800	1200	56	12505	£486.00
		2150 x 800 x 1000	2000 x 800	1200	62	12506	£614.00
		2160 x 800 x 1000	2000 x 800	1200	66	12516	£649.00
<b>B</b>	PANEL END PLATFORM TROLLEYS	1160 x 700 x 1000	1000 x 700	1200	45	12512	£399.00
		1360 x 800 x 1000	1200 x 800	1200	52	12513	£441.00
		1760 x 800 x 1000	1600 x 800	1200	60	12515	£516.00
		2160 x 800 x 1000	2000 x 800	1200	66	12516	£649.00
		2160 x 800 x 1000	2000 x 800	1200	66	12516	£649.00
<b>C</b>	DOUBLE PANEL END PLATFORM TROLLEYS	1230 x 700 x 1000	1000 x 700	1200	52	12522	£462.00
		1430 x 800 x 1000	1200 x 800	1200	59	12523	£511.00
		1830 x 800 x 1000	1600 x 800	1200	67	12525	£590.00
		2230 x 800 x 1000	2000 x 800	1200	73	12526	£720.00
		2230 x 800 x 1000	2000 x 800	1200	73	12526	£720.00
<b>D</b>	TWO SHELF TABLE TOP CARTS	1210 x 700 x 925	1000 x 700	1200	63	12402	£528.00
		1410 x 800 x 925	1200 x 800	1200	73	12403	£614.00
		1810 x 800 x 925	1600 x 800	1200	90	12405	£774.00
		2210 x 800 x 925	2000 x 800	1200	106	12406	£1010.00
		2210 x 800 x 925	2000 x 800	1200	106	12406	£1010.00
<b>E</b>	3 SIDED PLATFORM TROLLEYS	1230 x 715 x 1000	1000 x 700	1200	58	12532	£581.00
		1430 x 815 x 1000	1200 x 800	1200	69	12533	£625.00
		1830 x 815 x 1000	1600 x 800	1200	81	12535	£738.00
		2230 x 815 x 1000	2000 x 800	1200	92	12536	£870.00
		2230 x 815 x 1000	2000 x 800	1200	92	12536	£870.00
<b>F</b>	4 SIDED BOX CARTS	1230 x 715 x 1000	1000 x 700	1200	64	12552	£656.00
		1430 x 815 x 1000	1200 x 800	1200	78	12553	£704.00
		1830 x 815 x 1000	1600 x 800	1200	93	12555	£846.00
		2230 x 815 x 1000	2000 x 800	1200	108	12556	£1004.00
		2230 x 815 x 1000	2000 x 800	1200	108	12556	£1004.00
<b>G</b>	THREE SHELF TABLE TOP CARTS	1210 x 700 x 925	1000 x 700	1200	86	12422	£713.00
		1410 x 800 x 925	1200 x 800	1200	98	12423	£856.00
		1810 x 800 x 925	1600 x 800	1200	121	12425	£1077.00
		2210 x 800 x 925	2000 x 800	1200	145	12426	£1432.00
		2210 x 800 x 925	2000 x 800	1200	145	12426	£1432.00



## Ecoline Trolleys

### Ecoline Trolleys ✓ 200kg / 400kg capacity ✓ Comply with EuroNorm 1757-3

- Tubular welded steel construction
- Beech faced particle board decks
- 2 fixed castor wheels, 2 swivel with brake
- Cushion rubber tyres on roller bearing wheels
- Powder coated finish RAL blue 5007

★ **BEST** ★  
**SELLERS**



1200  
**£147**



2100  
**£178**



1602  
**£241**

**Storeroom Trolleys**

**Table Top Cart**

Shelf heights 185 & 810mm

#### Storeroom Trolleys

CAPACITY (kg)	OUTER DIMENSIONS H x L x W (mm)	PLATFORM SIZE L x W (mm)	WHEEL DIA (mm)	WEIGHT (kg)	ORDER REF	PRICE
200	900 x 1100 x 450	850 x 450	125	15	1200	£147.00
200	900 x 1250 x 600	1000 x 600	125	20	1202	£171.00
400	945 x 1030 x 505	850 x 500	160	21	2100	£178.00
400	985 x 1180 x 705	1000 x 700	200	29	2102	£195.00



#### A4 Clipboard

Wood, with paperclip and pencil holder.

**REF 1290 PRICE £33.60**

**RAPID  
DELIVERY**



**5** years  
**QUALITY  
GUARANTEE**

#### Table Top Carts



1800  
**£257**



2600  
**£266**



2610  
**£326**

Shelf heights 185, 500 & 810mm

Shelf heights 225 & 720mm

Shelf heights 225, 473 & 720mm

#### Table Top Carts

CAPACITY (kg)	HANDLES	OUTER DIMENSIONS H x L x W (mm)	PLATFORM SIZE L x W (mm)	TOP SHELF LOAD (kg)	WHEEL DIA (mm)	WEIGHT (kg)	ORDER REF	PRICE
200	2	1010 x 1030 x 500	850 x 500	80	125	25	1600	£205.00
200	2	1010 x 1180 x 600	1000 x 600	80	125	28	1602	£241.00
200	2	1010 x 1030 x 500	850 x 500	80 TOP & MIDDLE	125	34	1800	£257.00
200	2	1010 x 1180 x 600	1000 x 600	80 TOP & MIDDLE	125	40	1802	£300.00
300	1	960 x 970 x 505	850 x 500	120	160	29	2600	£266.00
400	1	1000 x 1120 x 705	1000 x 700	120	200	41	2602	£291.00
300	1	960 x 970 x 505	850 x 500	120 TOP & MIDDLE	160	36	2610	£326.00
400	1	1000 x 1120 x 705	1000 x 700	120 TOP & MIDDLE	200	51	2612	£356.00





## Heavy Duty Shelf & Tray Trolleys

- ✓ Complies with EuroNorm 1757-3 ✓ 500kg frame capacity ✓ 90kg max on each upper shelf

- All steel welded construction • Powder coated RAL blue 5007
- Beech grain laminated surfaces • 2 fixed and 2 swivel / brake castor wheels

**5** years  
QUALITY  
GUARANTEE

MATERIALS HANDLING

SOME ITEMS ON THIS  
PAGE WILL BE SUPPLIED  
IN KD FORM



### Shelf Trolleys

DIMENSIONS* W x D x H (mm)	SHELF LEVELS	SHELF HEIGHTS (mm)	WHEEL DIA (mm)	ORDER REF	PRICE
1000 x 600 x 1100	3	270 - 630 - 990	200	8101	£344.00
1000 x 700 x 1100	3	270 - 630 - 990	200	8102	£383.00
1200 x 800 x 1100	3	270 - 630 - 990	200	8103	£443.00
1000 x 600 x 1500	4	270 - 630 - 990 - 1350	200	8201	£410.00
1000 x 700 x 1500	4	270 - 630 - 990 - 1350	200	8202	£442.00
1200 x 800 x 1500	4	270 - 630 - 990 - 1350	200	8203	£512.00
1000 x 600 x 1800	4	270 - 700 - 1100 - 1500	200	8301	£420.00
1000 x 700 x 1800	4	270 - 700 - 1100 - 1500	200	8302	£447.00
1200 x 800 x 1800	4	270 - 700 - 1100 - 1500	200	8303	£514.00

\*WIDTH EXCLUDES HANDLE PROJECTION



### Tray Trolleys

DIMENSIONS* W x D x H (mm)	SHELF LEVELS	SHELF HEIGHTS (mm)	WHEEL DIA (mm)	ORDER REF	PRICE
1000 x 600 x 1100	3	270 - 630 - 990	200	8121	£527.00
1000 x 700 x 1100	3	270 - 630 - 990	200	8122	£547.00
1200 x 800 x 1100	3	270 - 630 - 990	200	8123	£645.00
1000 x 600 x 1500	4	270 - 630 - 990 - 1350	200	8221	£611.00
1000 x 700 x 1500	4	270 - 630 - 990 - 1350	200	8222	£645.00
1200 x 800 x 1500	4	270 - 630 - 990 - 1350	200	8223	£753.00
1000 x 600 x 1800	4	270 - 700 - 1100 - 1500	200	8321	£614.00
1000 x 700 x 1800	4	270 - 700 - 1100 - 1500	200	8322	£647.00
1200 x 800 x 1800	4	270 - 700 - 1100 - 1500	200	8323	£757.00

\*WIDTH EXCLUDES HANDLE PROJECTION



## Table Top Carts

## Table Top Carts 250kg

- ✓ Complies with EuroNorm 1757-3 for enhanced operator safety
- ✓ 250kg capacity
- ✓ 80kg capacity on upper and middle shelves
- Tubular steel construction • Quality powder coating • 12mm top lip • Shelves made from derived timber board, on angle steel frame
- Angled or horizontal push bar • Two swivel, two fixed wheels • 125mm diameter solid rubber tyres

★ **BEST** ★  
**SELLERS**

## Table Top Carts

TROLLEY TYPE	PLATFORM SIZE L x W (mm)	SHELF HEIGHTS (mm)	NUMBER & SIZE OF DRAWERS	PUSHBAR TYPE	ORDER REF	PRICE
TWO SHELVES	850 x 500	195 - 820	-	HORIZONTAL	2940	£232.00
TWO SHELVES	1000 x 600	195 - 820	-	HORIZONTAL	2942	£257.00
THREE SHELVES	850 x 500	195 - 508 - 820	-	HORIZONTAL	2950	£307.00
THREE SHELVES	1000 x 600	195 - 508 - 820	-	HORIZONTAL	2952	£334.00
TWO SHELVES + 2 DRAWERS	1000 x 600	195 - 820	TWO: 105 x 415 x 490	HORIZONTAL	2922	£590.00
TWO SHELVES	850 x 500	195 - 820	-	ANGLED	2740	£228.00
TWO SHELVES	1000 x 600	195 - 820	-	ANGLED	2742	£254.00
THREE SHELVES	850 x 500	195 - 508 - 820	-	ANGLED	2750	£299.00
THREE SHELVES	1000 x 600	195 - 508 - 820	-	ANGLED	2752	£331.00
TWO SHELVES + 2 DRAWERS	1000 x 600	195 - 820	TWO: 105 x 415 x 490	ANGLED	2622	£586.00



## Table Top Carts - 250kg with Retention Rim

- ✓ 250kg capacity
- ✓ 80kg capacity on upper and middle shelves
- ✓ Complies with EuroNorm 1757-3

- Tubular steel construction • Quality powder coating • Shelves made from derived timber board, on angle steel frame
- 50mm high load retention rims • Angled or horizontal push bar • Two swivel, two fixed wheels • 125mm diameter solid rubber tyres



## Table Top Carts with Rim

PLATFORM SIZE L x W (mm)	50mm RETENTION RIM	NUMBER & SIZE OF DRAWERS	PUSHBAR TYPE	ORDER REF	PRICE
850 x 500	TOP SHELF	-	HORIZONTAL	3940	£254.00
1000 x 600	TOP SHELF	-	HORIZONTAL	3942	£283.00
850 x 500	TOP & BOTTOM	-	HORIZONTAL	3960	£276.00
1000 x 600	TOP & BOTTOM	-	HORIZONTAL	3962	£311.00
1000 x 600	BOTTOM SHELF	TWO: 105 x 415 x 490	HORIZONTAL	3922	£609.00
850 x 500	TOP SHELF	-	ANGLED	3740	£250.00
1000 x 600	TOP SHELF	-	ANGLED	3742	£280.00
850 x 500	TOP & BOTTOM	-	ANGLED	3760	£273.00
1000 x 600	TOP & BOTTOM	-	ANGLED	3762	£307.00
1000 x 600	BOTTOM SHELF	TWO: 105 x 415 x 490	ANGLED	3622	£605.00

**5** years  
**QUALITY  
GUARANTEE**SOME ITEMS ON THIS  
PAGE WILL BE SUPPLIED  
IN KD FORM





## All Steel Workshop Carts ✓ Welded oil-tight trays suit engineering use

- 2 swivel castors with brake, 2 fixed wheels
- Solid rubber tyres with roller bearings
- Powder coated in RAL blue 5007

**5** years  
QUALITY  
GUARANTEE

All items  
on this  
page



TROLLEY TYPE	SHELF HEIGHT (mm)	TRUCK CAPACITY (kg)	WHEEL DIA (mm)	PLATFORM SIZE L x W (mm)	ORDER REF	PRICE
2 TRAYS (40mm RIM) HORIZONTAL PUSH BAR	245 - 865	400	160	850 x 500	4820	£290.00
2 TRAYS (40mm RIM) HORIZONTAL PUSH BAR	290 - 910	400	200	1000 x 700	4822	£344.00
3 TRAYS (40mm RIM) HORIZONTAL PUSH BAR	245 - 555 - 865	400	160	850 x 500	4830	£360.00
3 TRAYS (40mm RIM) HORIZONTAL PUSH BAR	290 - 600 - 910	400	200	1000 x 700	4832	£438.00
2 TRAYS (40mm RIM) ANGLED PUSH BAR	245 - 865	400	160	850 x 500	4920	£284.00
2 TRAYS (40mm RIM) ANGLED PUSH BAR	290 - 910	400	200	1000 x 700	4922	£339.00
3 TRAYS (40mm RIM) ANGLED PUSH BAR	245 - 555 - 865	400	160	850 x 500	4930	£355.00
3 TRAYS (40mm RIM) ANGLED PUSH BAR	290 - 600 - 910	400	200	1000 x 700	4932	£432.00
LATTICE GRILLE, CATCH TRAY, DRAIN TAP	195 - 890	250	125	1000 x 600	2722	£430.00

SOME ITEMS ON THIS  
PAGE WILL BE SUPPLIED  
IN KD FORM



## Heavy Duty Carts 500kg

- ✓ 500kg truck capacity
- ✓ 200kg capacity on shelves above base
- ✓ Resistant to impact and scratches

- Durable all steel welded frames
- Powder coated finish RAL blue 5007
- Beech grain laminated surfaces
- Optional platforms with galvanized steel sheet plating
- Two swivel and two fixed wheels
- Brakes fitted to swivel castors
- 200 x 50mm solid rubber tyres



Galvanized Platforms

1000 x 700mm

REF 1278 PRICE £62.00 (per shelf)

1200 x 800mm

REF 1279 PRICE £76.00 (per shelf)



TROLLEY TYPE	SHELF HEIGHT (mm)	TRUCK CAPACITY (kg)	WHEEL DIA (mm)	PLATFORM SIZE L x W (mm)	ORDER REF	PRICE
2 TIMBER SHELVES	275 - 905	500	200	1000 x 600	2401	£318.00
2 TIMBER SHELVES	275 - 905	500	200	1000 x 700	2402	£324.00
2 TIMBER SHELVES	275 - 905	500	200	1200 x 800	2403	£345.00
3 TIMBER SHELVES	275 - 590 - 905	500	200	1000 x 700	2422	£464.00
3 TIMBER SHELVES	275 - 590 - 905	500	200	1200 x 800	2423	£502.00
4 TIMBER SHELVES	275 - 590 - 905 - 1220	500	200	1000 x 700	2442	£590.00
4 TIMBER SHELVES	275 - 590 - 905 - 1220	500	200	1200 x 800	2443	£634.00



## Stainless Steel Trolleys



## Stainless Steel Trolleys

✓ Suit hygiene &amp; clean area applications

- 610 x 410mm pressed trays with all-round rim
- Maximum capacity 100kg, 50kg maximum on upper shelves
- 100mm castor wheels with non-marking grey rubber tyres
- Two wheels fitted with brake to comply with EuroNorm 1757-3
- Supplied flat packed, for simple on-site assembly

MODEL	OVERALL SIZE L x W x H (mm)	SHELF HEIGHTS (mm)	WEIGHT (kg)	ORDER REF	PRICE
2 TIER	680 x 450 x 900	175, 785	7	3142	£220.00
3 TIER	680 x 450 x 900	175, 480, 785	9	3143	£289.00

★ NEW ★  
**PRODUCTS**



**5** years  
**QUALITY  
GUARANTEE**

  
SUPPLIED IN KD FORM



## Modular Stainless Steel Trolleys

✓ 2, 3 &amp; 4 tray models

✓ Versatile modular system

- Tubular CNS (chrome nickel steel)
- Supplied in KD form for easy on-site assembly
- Deep-drawn shelves with all-round rim
- Corner protectors and shielded wheels safeguard furniture
- 125mm castor wheels with non-marking tyres
- 2 braked wheels comply with Euronorm 1757-3
- 80kg load capacity per shelf

OVERALL DIMENSIONS H x W x D (mm)	PLATFORM SIZE L x W (mm)	NO. OF SHELVES	SHELF HEIGHTS (mm)	WEIGHT (kg)	ORDER REF	PRICE
950 x 700 x 470	630 x 400	2	265, 850	12	5036	£355.00
950 x 700 x 470	630 x 400	3	300, 575, 850	14.5	5038	£427.00
950 x 870 x 570	800 x 500	2	265, 850	15	5001	£314.00
950 x 870 x 570	800 x 500	3	300, 575, 850	17	5005	£383.00
1260 x 870 x 570	800 x 500	4	335, 610, 885, 1160	22	5009	£629.00
950 x 1070 x 570	1000 x 500	2	265, 850	16	5011	£436.00
950 x 1070 x 570	1000 x 500	3	300, 575, 850	19	5013	£499.00
1260 x 1070 x 570	1000 x 500	4	335, 610, 885, 1160	25	5015	£680.00
950 x 1070 x 670	1000 x 600	2	265, 850	17	5017	£425.00
950 x 1070 x 670	1000 x 600	3	300, 575, 850	22	5019	£513.00
1260 x 1070 x 670	1000 x 600	4	335, 610, 885, 1160	28	5021	£757.00



## Plastic Base Trolleys

- ✓ Manoeuvrable, strong and light
- ✓ 120kg - 300kg capacities
- Reinforced plastic platforms
- High quality chromium plated metalwork
- Two fixed, two swivel ball bearing castors
- Polyurethane tyred wheels



**NPLA-T2**  
**£100**



**PLA-300**  
**£110**

**300kg**  
CAPACITY

**RAPID**  
**DELIVERY**

SOME ITEMS ON THIS  
PAGE WILL BE SUPPLIED  
IN KD FORM

SUPERIOR PLASTIC BASED  
TROLLEYS FOR USE  
WHERE APPEARANCE OR  
HYGIENE MATTERS!



**NPLA-T3**  
**£121**



**NPLA-150-T2-HL**  
**£110**

TROLLEY TYPE	CAPACITY (kg)	WHEEL DIA (mm)	OUTSIDE DIMENSIONS L x W x H (mm)	HANDLE HEIGHT (mm)	WEIGHT (kg)	ORDER REF	PRICE
FOLDING SINGLE END TROLLEY	120	100	740 x 480 x 835	835	10	NPLA-SDX-M	£73.00
	150	100	730 x 490 x 900	900	10	PLA-150	£80.00
	200	125	810 x 500 x 880	880	14	NPLA-SDX	£106.00
	300	125	910 x 600 x 880	880	16	PLA-300	£110.00
TWO SHELF TROLLEY	200	125	810 x 500 x 920	920	21	NPLA-T2	£100.00
TWO SHELF TROLLEY WITH WIRE RIM	150	100	790 x 490 x 850	850	14	NPLA-150-T2-HL	£110.00
THREE SHELF TROLLEY	200	125	810 x 500 x 920	920	26	NPLA-T3	£121.00



## Platform Trolleys

### Folding Optiliner

✓ 400kg capacity

- Tubular steel frame, powder coated finish
- Ergonomic hinged grip
- Easy pedal operated unlock facility
- Derived timber material boards with coloured plastic surface
- Overall dimensions 975H x 620W x 975L
- Platform size 900L x 600Wmm
- Loading height 235mm
- 2 swivel, 2 fixed 160mm diameter castors

★ **BEST** ★  
**SELLER**

### Folding Optiliner

Blue/red **REF 3301** **PRICE £255.00**  
Grey/yellow **REF 3302** **PRICE £261.00**



Safe vertical stacking



Safe horizontal stacking



### Optiliner Table Top Cart

✓ 400kg capacity, 200kg maximum on upper shelf

- Tubular steel frame, powder coat finish
- Derived timber material boards with coloured plastic surface
- Overall dimensions 975H x 600W x 1050Lmm
- Platform size 900L x 600Wmm
- Shelf heights 235mm and 800mm
- 2 swivel, 2 fixed 160mm diameter castors

### Optiliner Table Top Cart

Blue/red **REF 3601** **PRICE £306.00**  
Grey/yellow **REF 3602** **PRICE £319.00**

**RAPID**  
**DELIVERY**



**5** years  
**QUALITY**  
**GUARANTEE**



### Steel Folding Trolleys

✓ Robust trolleys for loads 150/250kg

- Tubular steel frame, powder coat finish
- Derived timber platform with beech grain finish



### Aluminium Folding Trolleys

✓ Lightweight trolleys for 150kg loads

- Tubular aluminium cart with aluminium platform
- Complies with EuroNorm 1757-3

TYPE	CAPACITY (kg)	PLATFORM L x W (mm)	CASTORS DIA (MM)	WEIGHT (KG)	ORDER REF	PRICE
MINI	150	720 x 450	125	16	KW1	£196.00
MAXI	250	900 x 600	160	25	KW11	£237.00

TYPE	CAPACITY (kg)	PLATFORM L x W (mm)	CASTORS DIA (MM)	WEIGHT (KG)	ORDER REF	PRICE
MINI	150	720 x 450	125	11	KW2	£318.00
MAXI	150	900 x 600	160	18	KW12	£414.00





## Folding Mover Trolleys

- ✓ Universal quick-fold trolleys for the office, stores or boot of the car!
- Tough sheet steel construction
- Acrylic paint with non-slip platform covering
- Rubber tyred castors give excellent manoeuvrability

CAPACITY (kg)	PLATFORM L x W (mm)	CASTORS DIA (MM)	WEIGHT (KG)	ORDER REF	PRICE
150	735 x 475	100	11	NB101	£62.00
300	110 x 610	130	19	NB301	£107.00

**RAPID  
DELIVERY**



## Fold / Extend Trolley

- ✓ The real space saver! Folds and extends
- Super lightweight aluminium • Weighs only 5kg
- 150kg capacity • 100mm rubber castors
- Extends to give a platform 725L x 420Wmm
- Folds away to only 500L x 420Wmm

REF AFT/1 PRICE £67.00



## Tray & Container Trolleys

- ✓ 150kg capacity
- Generous 740 x 480mm non-slip PVC covered steel platforms
- Easy steering on 100mm castors • Chromium plated metalwork • PVC buffers all round



TROLLEY TYPE	OVERALL HEIGHT (mm)	TRAY HEIGHT (mm)	CONTAINER HEIGHT (mm)	WEIGHT (kg)	ORDER REF	PRICE
2-TRAY	880	150 - 700	-	22	MTS-T2	£75.00
3-TRAY	880	150 - 425 - 700	-	27	MTS-T3	£89.00
SINGLE CONTAINER	850	150	600	25	NB107	£200.00



## Roll Containers



**RAPID  
DELIVERY**

Cage labelling  
wrap-around  
pockets, page 83



## Regular Demountables



### Demountable Roll Containers 500kg Capacity

- The standard industrial roll container, widely used throughout Europe
- Fully demountable for return loads and storage
- Assembles quickly when required
- Bright zinc electroplated finish
- Smooth running nylon castors - 2 fixed & 2 swivel
- Wire base cannot harbour dust
- Shelves can be added as required
- 100mm wide rod mesh sides
- Two straps supplied

### Demountable Roll Containers 500kg Capacity

DESCRIPTION AND OVERALL H x W x D (mm)	INTERNAL HT (mm)	CASTORS (mm)	ORDER REF	PRICE
2 SIDED UNIT 1520 x 715 x 800	1360	100	17.968.2	£103.00
3 SIDED UNIT 1520 x 715 x 800	1360	100	17.968.3	£128.00
4 SIDED* UNIT 1520 x 715 x 800	1360	100	17.968HG	£164.00
2 SIDED UNIT 1700 x 715 x 800	1530	100	17.978.2	£105.00
3 SIDED UNIT 1700 x 715 x 800	1530	100	17.978.3	£129.00
4 SIDED* UNIT 1700 x 715 x 800	1530	100	17.978HG	£168.00
2 SIDED UNIT 1800 x 715 x 800	1630	100	17.988.2	£105.00
3 SIDED UNIT 1800 x 715 x 800	1630	100	17.988.3	£132.00
4 SIDED* UNIT 1800 x 715 x 800	1630	100	17.988HG	£175.00
SHELF 715 x 800	-	-	17.768	£9.00

\*4 sided models have easy loading half drop removable gate on one short side

## Jumbo Demountables

- Extra large capacity
- Euro standard base 1200 x 800mm
- Bright zinc electroplated finish
- 500kg capacity
- 100mm wide rod mesh sides
- Use 3-sided with sleeves for mobile storage applications

### 3 Sided Jumbo

- Overall 1800H x 1200W x 800Dmm
- Internal height 1630mm
- 125mm castors

REF 17.200.03 PRICE £166.00

### 4 Sided Jumbo\*

REF 17.200HG PRICE £203.00

### Jumbo Shelf

REF 17.39503 PRICE £25.00

\*4 sided models have easy loading  
half drop removable gate on one short side







## Plastic Base Roll Containers

- ✓ Hygienic and quiet
- ✓ Stands out from the crowd

- 500kg load • 2 or 3 sides
- Red plastic base with steel reinforcement
- Steel sides are epoxy coated yellow
- Side infill 140 x 340mm • Optional shelves
- 3rd side and shelf are wire formed, with zinc plated finish

### Plastic Base Roll Containers

MODEL	INTERNAL H x W x D (mm)	OVERALL HEIGHT (mm)	WEIGHT (kg)	CASTOR DIA (mm)	ORDER REF	PRICE
2-SIDED	1450 x 720 x 815	1630	21.5	100	18.978.2	£105.00
3-SIDED	1450 x 720 x 815	1630	24	100	18.978.3	£126.00
SHELF	715 x 800	-	2	-	17-768	£9.00

## Nestable Roll Containers

- ✓ Space saving A-frame base design
- ✓ Folds quickly to rest in compact blocks

- 3-sided, 4-sided and security models
- 600kg capacity • Large 125mm nylon castors
- Optional hinged shelf • Bright zinc electroplated finish

**RAPID  
DELIVERY**

**NESTABLE FOR  
COMPACT STORAGE**



3-Sided

19.A116  
**£120**



### 3 & 4-Sided Nestable

- 1725H x 735W x 865Dmm
- Internal height 1460mm
- Side mesh 130 x 405mm

3-SIDED Weight 50kg  
REF 19.A116 PRICE £120.00

4-SIDED Weight 54kg  
REF 19.A116/4 PRICE £131.00

### Security Enclosed

- 1725H x 735W x 865Dmm
- Internal height 1460mm
- Side mesh 50 x 50mm
- Weight 58kg

REF 19.A110 PRICE £154.00

Optional Hinged Shelf

REF 19.768 PRICE £9.00



Security Enclosed

COMPLETE  
19.A110+19.768  
**£163**



COMPLETE  
18.978.2 + 17-768  
**£114**

OPTIONAL SHELF

## Security Demountables

- ✓ For 'high risk' loads
- ✓ Can be padlocked or security tagged

17.470  
**£274**

- 500kg capacity
- 50 x 50mm mesh walls and top
- Demounts for storage, can be stowed '4 in 1'



### Regular Security

- 1840H x 720W x 805Dmm
- lockable gate
- 100mm castors

REF 17.470 PRICE £274.00

### Jumbo Security

- 1850H x 1200W x 800Dmm
- lockable wardrobe doors
- 125mm castors

REF 17.480 PRICE £405.00



## Parcel &amp; Box Carts



8181-1  
**£400**



8281-1  
**£419**



8382-1  
**£456**

## Parcel Carts 500kg

✓ Rugged tubular carts for parcels or components

- 3-Sided for easy access, or with removable fourth side
- Complies with EuroNorm 1757-3
- Platform height 270mm
- 200mm cushion tyred wheels

DIMENSIONS L x W x H (mm)	3-SIDED		4-SIDED	
	REF	PRICE	REF	PRICE
1000 x 600 x 1100	8181-1	£400.00	8181-2	£509.00
1000 x 700 x 1100	8182-1	£420.00	8182-2	£528.00
1200 x 800 x 1100	8183-1	£455.00	8183-2	£568.00
1000 x 600 x 1500	8281-1	£419.00	8281-2	£535.00
1000 x 700 x 1500	8282-1	£442.00	8282-2	£560.00
1200 x 800 x 1500	8283-1	£476.00	8283-2	£596.00
1000 x 600 x 1800	8381-1	£431.00	8381-2	£547.00
1000 x 700 x 1800	8382-1	£456.00	8382-2	£571.00
1200 x 800 x 1800	8383-1	£491.00	8383-2	£614.00



**FROM  
£836**

**5** years  
**QUALITY  
GUARANTEE**



**SOME ITEMS ON THIS  
PAGE WILL BE SUPPLIED  
IN KD FORM**

## Heavy Duty Box Carts 750kg

✓ Rugged angle steel frames

- Open front or with padlockable rod system doors
- Complies with EuroNorm 1757-3
- 1790mm high overall
- 200 x 50mm rubber tyred castors
- Platform height 285mm
- 4 adjustable wood material shelves
- Shelves at 575, 875, 1175, 1475mm
- Powder coated RAL blue 5007

DESCRIPTION	DIMENSIONS L x W (mm)	ORDER REF	PRICE
OPEN FRONT	1000 x 680	3392	£836.00
	1200 x 780	3393	£993.00
LOCKABLE DOORS	1000 x 680	4392	£1136.00
	1200 x 780	4393	£1395.00



## Boxwell Mobile Shelving

- ✓ Flexible mobile storage
- ✓ Suits work in progress and finished goods
- ✓ Can be sited underneath racking to provide an integrated storage system
- 900mm wide x 600mm deep units for easy gangway access
- 1200/1500/1800mm height options
- Supplied fully assembled with steel top & base and 75x25mm steel mesh back & sides
- 500kg capacity per unit and 100kg per shelf (UDL)
- Supplied with two adjustable shelves (mesh or ply) – extra shelves available
- Two fixed & two swivel castors for easy steer
- Units available with or without security doors
- Durable powder coated finish – blue (other colours available)



OVERALL DIMENSIONS H x W x D (mm)	SHELF MATERIAL	OPEN FRONT UNIT		UNIT WITH SECURITY DOORS (FACTORY FITTED)		EXTRA SHELF (MESH OR PLY TO SUIT UNIT)	
		ORDER REF	PRICE	ORDER REF	PRICE	ORDER REF	PRICE
1355 x 900 x 600	MESH	XW139060MBXX	£441.00	XD139060MBXX	£557.00	XWES9060MBXX	£39.90
1355 x 900 x 600	PLY	XW139060PBXX	£465.00	XD139060PBXX	£580.00	XWES9060PBXX	£48.30
1655 x 900 x 600	MESH	XW169060MBXX	£466.00	XD169060MBXX	£587.00	XWES9060MBXX	£39.90
1655 x 900 x 600	PLY	XW169060PBXX	£489.00	XD169060PBXX	£610.00	XWES9060PBXX	£48.30
1955 x 900 x 600	MESH	XW199060MBXX	£487.00	XD199060MBXX	£617.00	XWES9060MBXX	£39.90
1955 x 900 x 600	PLY	XW199060PBXX	£510.00	XD199060PBXX	£642.00	XWES9060PBXX	£48.30

## Wire Mesh Box Trucks

- ✓ Load is visible at all times
- ✓ Corner mounted wheels offer best stability for heavier loads
- Choice of body styles
- Light duty 150kg or heavy duty 500kg
- 50 x 50mm wire mesh grid
- All steel welded frames
- Easy steer wheels pivot about centre axis
- 200 x 50mm cushion rubber tyres

**RAPID  
DELIVERY**  
ON SELECTED ITEMS

SOME ITEMS ON THIS  
PAGE WILL BE SUPPLIED  
IN KD FORM



PIC	CAPACITY	OVERALL SIZE L x W x H (mm)	INTERNAL SIZE L x W x H (mm)	BODY TYPE / FEATURES	WHEEL STYLE	ORDER REF	PRICE
A	LIGHT DUTY 150kg	1251 x 711 x 940	914 x 660 x 660	ANGLE FRAME, HALF OPEN SIDE	EASY STEER	T30	£271.00
B	LIGHT DUTY 150kg	1251 x 711 x 940	914 x 660 x 660	ANGLE FRAME, HALF HINGED SIDE	EASY STEER	T31	£295.00
C	HEAVY DUTY 500kg	1060 x 715 x 1075	1000 x 700 x 700	TUBULAR FRAME, HALF HINGED SIDE	2 FIXED, 2 SWIVEL	2772	£467.00
		1260 x 815 x 1075	1200 x 800 x 700		2 FIXED, 2 SWIVEL	2773	£501.00
D	HEAVY DUTY 500kg	1130 x 725 x 1120	1000 x 700 x 800	ANGLE FRAME, HALF HINGED SIDE,	2 FIXED, 2 SWIVEL	2762	£651.00
		1330 x 825 x 1120	1200 x 800 x 800	DOUBLE HINGED LID WITH LOCKABLE EYELETS	2 FIXED, 2 SWIVEL	2763	£693.00



## Distribution Trolleys

## Double Container Trolleys

✓ Light and easily manoeuvred in tight areas

- Universal distribution trolleys, used in most high street stores and many industrial warehouses
  - Zinc plated frame with smooth running 125mm castors
- With grey/light grey open containers or green containers with captive folding lids
- Spare containers are always available - please call for prices

**Grey Container Model**

Trolley supplied with 2 containers:

1070H x 510W x 915Dmm

Containers 315H x 350W x 570L internal

**REF T151G PRICE £216.00**

**Green Container Model**

Trolley supplied with 2 containers:

1000H x 440W x 970Dmm

Containers 285H x 335W x 510L internal

**REF T5101 PRICE £227.00**



Quality products  
British made with  
long life in mind



2 IN 1 CARGO  
PLATFORM &  
SACK TRUCK

**Cargo Truck**

✓ Cargo truck and sack truck in one compact design

✓ Load capacity 250kg

- Dimensions as sack truck with toe plate 1175H x 390W x 585Dmm
- Dimensions as platform truck 930H x 390W x 1175Lmm
- Weight 16kg • Toe plate 335W x 310Dmm
- 2 x 260mm pneumatic wheels
- 2 x 100mm rubber tyred swivel castors

**REF CS352 PRICE £147.00**

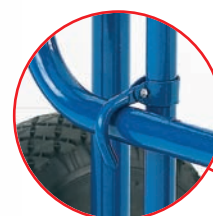

Steel hook holds  
back plate  
to main frame



**RAPID  
DELIVERY**



**RAPID  
DELIVERY**

## Cash & Carry Trolleys

- ✓ Complies with EuroNorm 1757-3 for enhanced operator safety



### Single Deck Cash & Carry Trolleys

- Tubular steel frame
- Powder coated finish
- Anti-slip waterproof plywood board platform
- Platform height 265/310mm
- Total width 650/750/850mm
- 2 fixed and 2 swivel castors
- Solid rubber tyres



### Double Deck Cash & Carry Trolleys

- Tubular steel frame
- Powder coated finish
- Anti-slip waterproof plywood board platforms
- Upper shelf capacity 80kg
- 2 fixed and 2 swivel castors
- Solid rubber tyres

## Nesting Cash & Carry Trolley

- ✓ Rugged sprung base trolley
- ✓ Capacity 400kg

- Nests for compact multiple storage
- Platform 1200L x 585Wmm
- 125mm rubber tyred wheels (2 fixed and 2 swivel)

**REF T290  
PRICE £230.00**
**2 years  
GUARANTEE**

Spring-loaded platform for easy nesting



75% space saving when trolleys are nested!

**FROM  
£325**

**5 years  
QUALITY  
GUARANTEE**

### Long Load Cash & Carry Trolleys

- Tubular steel frame
- Powder coated finish
- Two 680mm high lateral frames
- Two 500mm high lateral frames
- Anti-slip waterproof plywood board platform
- Platform interior width 435/535/635mm
- 2 fixed and 2 swivel castors
- Solid rubber tyres



Accessories - A4 clipboard and wire basket are available for cash & carry trolleys - see page 136

### Cash & Carry Trolleys

MODEL DESCRIPTION	PLATFORM SIZE L x W (mm)	CAPACITY (kg)	WHEEL DIAMETER (mm)	ORDER REF	PRICE
SINGLE DECK TROLLEYS	850 x 500	400	160	2960	£281.00
	1000 x 600	500	200	2961	£302.00
	1000 x 700	500	200	2962	£312.00
DOUBLE DECK TROLLEYS	850 x 500	400	160	2970	£403.00
	1000 x 600	500	200	2971	£461.00
	1000 x 700	500	200	2972	£478.00
LONG LOAD TROLLEYS	850 x 500	400	160	2980	£325.00
	1000 x 600	500	200	2981	£347.00
	1000 x 700	500	200	2982	£353.00



## Trucks & Trolleys

### Four Wheeled Trucks

- ✓ 150kg Capacity
- ✓ Compact and manoeuvrable
- Flat platform and box body designs
- Platform 990L x 533Wmm optional 125mm high body
- 200mm rubber tyred wheels

Flat Platform Model

REF T88 PRICE £138.00

Box Body Type

REF T88/5 PRICE £150.00



### Firm Loading Trolley

- ✓ Excellent general purpose warehouse trolley, strong enough for regular retail use
- ✓ Capacity 250kg
- Tongued and grooved timber deck
- Platform 1067L x 610Wmm
- 200/125mm rubber tyred castors

REF GT42D PRICE £175.00



### Heavy Duty Balanced Platform Trolleys

- ✓ Ruggedly constructed for 400kg capacity
- ✓ Run easily and safely on uneven terrain
- ✓ Perfectly balanced on central axle to turn within their own length
- Selected 25mm tongued and grooved timber deck and end panels
- 400mm 4-ply pneumatic tyred wheels on roller bearings
- Optional removable sides 200mm high
- Steerable from both ends
- Welded steel frames



Heavy Duty Balanced Platform Trolleys

PLATFORM L x W (mm)	PLATFORM HEIGHT (mm)	O/A LENGTH (mm)	END PANEL HEIGHT (mm)	PLATFORM + ENDS		WITH REMOVABLE SIDES	
				REF	PRICE	REF	PRICE
1220 x 686	457	1676	203	T91	£233.00	T92	£304.00
1524 x 762	457	1982	203	T91A	£269.00	T92A	£351.00
1829 x 914	457	2286	203	T91B	£317.00	T92B	£410.00





OPTIONAL  
T-HANDLE  
STEERING

## Special Value Platform Trucks

✓ Immense 500, 750 & 1000kg capacities for intensive industrial use

- Two platform sizes
- Available as a single platform, fixed ends with slide in sides or fixed ends with hinged sides
- Steering by U-shaped drawbar
- All-steel welded construction, with selected tongued and grooved 25mm timber
- 400mm diameter pneumatic tyres fitted to roller bearing wheels cope with the roughest terrain
- Optional parking brake **REF PB PRICE £75.00**



FROM  
**£381**

FLAT PLATFORM

QUALITY  
TONGUED AND  
GROOVED  
25MM TIMBER



FROM  
**£494**

FIXED ENDS &  
SLIDE IN SIDES



FROM  
**£485**

FIXED ENDS &  
HINGED SIDES

HEAVY DUTY  
PNEUMATIC  
TYRES FOR ALL  
TERRAINS

### Platform Trucks

DESCRIPTION	CAPACITY (kg)	PLATFORM SIZE L x W (mm)	TYRE TYPE	HANDLE TYPE	ORDER REF	PRICE
FLAT PLATFORM	500	1525 x 711	PNEUMATIC	PRAM	T109PQPR	£381.00
	500	1828 x 762	PNEUMATIC	PRAM	T110PQPR	£412.00
	500	1525 x 711	SOLID	PRAM	T109PQCR	£464.00
	500	1828 x 762	SOLID	PRAM	T110PQCR	£495.00
	1000	1525 x 711	PNEUMATIC	T HANDLE	T111TQPR	£460.00
	1000	1828 x 762	PNEUMATIC	T HANDLE	T112TQPR	£517.00
	750	1525 x 711	SOLID	T HANDLE	T111TQCR	£543.00
	750	1828 x 762	SOLID	T HANDLE	T112TQCR	£600.00
	500	1525 x 711	PNEUMATIC	PRAM	T109ESPQPR	£494.00
	500	1828 x 762	PNEUMATIC	PRAM	T110ESPQPR	£523.00
FIXED ENDS & SLIDE IN SIDES	500	1525 x 711	SOLID	PRAM	T109ESPQCR	£578.00
	500	1828 x 762	SOLID	PRAM	T110ESPQCR	£606.00
	1000	1525 x 711	PNEUMATIC	T HANDLE	T111ESTQPR	£559.00
	1000	1828 x 762	PNEUMATIC	T HANDLE	T112ESTQPR	£625.00
	750	1525 x 711	SOLID	T HANDLE	T111ESTQCR	£642.00
	750	1828 x 762	SOLID	T HANDLE	T112ESTQCR	£708.00
	500	1525 x 711	PNEUMATIC	PRAM	T109HSPQPR	£485.00
	500	1828 x 762	PNEUMATIC	PRAM	T110HSPQPR	£575.00
FIXED ENDS & HINGED SIDES	500	1525 x 711	SOLID	PRAM	T109HSPQCR	£628.00
	500	1828 x 762	SOLID	PRAM	T110HSPQCR	£643.00
	1000	1525 x 711	PNEUMATIC	T HANDLE	T111HSTQPR	£615.00
	1000	1828 x 762	PNEUMATIC	T HANDLE	T112HSTQPR	£697.00
	750	1525 x 711	SOLID	T HANDLE	T111HSTQCR	£681.00
	750	1828 x 762	SOLID	T HANDLE	T112HSTQCR	£764.00



## Industrial Trolleys

### 250kg Multi Tier Workshop Trolleys ✓ Budget priced self assembly trolleys

- Load capacity 250kg • Easy to manoeuvre • Two & three shelf models • Grey enamel finish • Fitted with push/pull handle for total control
- Dimensions 805H x 635W x 1015Lmm • Shelf depth 85mm • 2 swivel and 2 fixed 125mm rubber castors



#### Three Tier Workshop Trolley

- Shelf heights 150 - 435 - 720mm • Weight 25kg
- Supplied in KD form for rapid on-site assembly

REF CS203 PRICE £221.00



#### Two Tier Workshop Trolley

- Shelf heights 150 - 720mm • Weight 19kg
- Supplied in KD form for rapid on-site assembly

REF CS202 PRICE £180.00

**RAPID  
DELIVERY**

### 500kg General Purpose Truck

- Load capacity 500kg • Ideal for transporting boxes and containers
- 1200L x 600Wm mesh platform and 275mm drop mesh sides
- 340mm pneumatic tyred steel centred wheels • Epoxy coated blue finish • Sides and ends interlock together
- Truck dimensions: 1035H x 615W x 1235Lmm • Weight: 43kg
- Supplied in KD form for rapid on-site assembly

REF C1201B PRICE £263.00



### 150kg Two Tier Tool Cart

- Load capacity 150kg • 2 shelf platform truck ideal for transporting boxes and tools
- Mesh shelves will not harbour workshop dirt
- Epoxy coated blue finish • 250mm pneumatic tyred steel centre wheels
- Dimensions: 825H x 510W x 980Lmm • Lower platform height: 335Hmm • Weight: 30kg
- Supplied in KD form for rapid on-site assembly

REF CS203B PRICE £247.00

SOME ITEMS ON THIS  
PAGE WILL BE SUPPLIED  
IN KD FORM



### 250kg Turntable Platform Truck

- Load capacity 250kg • Large platform ideal for transporting boxes and components
- Easy to manoeuvre turntable tug
- Mesh deck will not harbour workshop dirt • Epoxy coated blue finish • 250mm pneumatic tyred steel centre wheels
- Truck dimensions: 360H x 610W x 1220Lmm • Weight: 35kg
- Supplied in KD form for rapid on-site assembly

REF CS202B PRICE £196.00



## Sheet Metal Dump Trucks

- ✓ Suitable for pushing and for stacking ✓ Complies with EuroNorm 1757-3 for safety of platform trolleys

- Constructed from 2mm thick steel sheet, with double folded top rim
- Welded oil-tight
- Chassis made of 3mm thick canted steel, with integrated stacker pockets
- 2 braked castor wheels & 2 fixed wheels
- Solid rubber tyres 200 x 50mm with roller bearings
- Powder coated blue RAL 5007
- Kickplate and tilt lock
- Tubular steel handle

**5**  
years  
QUALITY  
GUARANTEE



**DRAINAGE TAP** with filter to separate liquids from solids  
**REF //A PRICE £34.00**



**WHEEL LOCKS AS STANDARD**

**i** Please note these models are manual tipping not self tipping

### Sheet Metal Dump Trucks

CAPACITY (LITRES)	BOX SIZE L x W x H (mm)	OUTER DIMENSIONS L x W x H (mm)	WITH WHEELS			WITHOUT WHEELS		
			EDGE HEIGHT (mm)	ORDER REF	PRICE	EDGE HEIGHT (mm)	ORDER REF	PRICE
250	1202 x 655 x 390	1332 x 713 x 766	766	4701	£602.00	534	4711	£541.00
450	1212 x 675 x 695	1353 x 732 x 1065	721	4702	£697.00	490	4712	£636.00
600	1320 x 800 x 715	1465 x 858 x 1088	828	4703	£762.00	598	4713	£701.00
800	1320 x 970 x 715	1465 x 1108 x 1088	828	4704	£1011.00	598	4714	£853.00

## Self-Tilting Boxes

- ✓ Complies with EuroNorm 1757-3 ✓ Self-tilting, fully-emptying boxes for tipping bulk goods - even extremely light goods automatically

- Sturdy welded 3mm sheet steel design
- Powder coated blue RAL5007
- Standard fitted forklift sleeves, anti-roll safety device and tilt lock
- Link chain as anti-skidding and anti-tilting safety device
- Optional set of polyamide 200 x 50mm wheels, 2 braked castors & 2 fixed fitted underneath the forklift sleeves (height +240mm)



**DRAINAGE TAP** for separating liquids from solids  
**REF 6006 PRICE £39.00**



**TRACTION CABLE** to activate tilting mechanism operated from forklift truck driver's seat **REF 6008 PRICE £34.00**

### Self-Tilting Boxes

CAPACITY (kg)	CONTENTS (LITRES)	WEIGHT (kg)	OUTER DIMENSIONS L x W x H (mm)	WITH WHEELS			WITHOUT WHEELS		
				EDGE HEIGHT (mm)	ORDER REF	PRICE	EDGE HEIGHT (mm)	ORDER REF	PRICE
1000	350	103	1300 x 730 x 830	955	6030/1567	£951.00	720	6030TB	£834.00
1500	600	131	1300 x 1120 x 830	955	6060/1567	£1065.00	720	6060TB	£948.00
2000	900	156	1300 x 1620 x 830	955	6090/1568	£1296.00	720	6090TB	£1048.00
2500	1200	188	1758 x 1182 x 1125	1250	6120/1568	£1444.00	1015	6120TB	£1196.00



## Trucks &amp; Carts



★ **BEST** ★  
**SELLER**

## 500kg Turntable Truck

✓ The ideal industrial work horse

- 1600 x 710mm platform
- 515mm platform height
- Precision turntable steering
- Cushion rubber or pneumatic tyres on roller bearing wheels

Pneumatic tyres 400 x 100mm

**REF T511P PRICE £346.00**

Cushion rubber tyres 400 x 100mm

**REF T511C PRICE £423.00**

**T511P**  
**£346**

**500kg**  
**Capacity**

## Hand Carts

- Tubular steel construction
- Quality powder coating
- 250mm high rail
- Water resistant plywood platform
- Wheels with pneumatic tyres
- Automatic non-slip parking brake

**5** years  
**QUALITY**  
**GUARANTEE**



### Hand Carts

MODEL TYPE	PLATFORM SIZE L x W (mm)	TOTAL WIDTH (mm)	CAPACITY (kg)	WHEEL DIAMETER (mm)	ORDER REF	PRICE
HAND CARTS 2 WHEELS, T-BAR HANDLE	795 x 445	680	200	260	41.03	£342.00
	845 x 545	830	400	400	41.04	£458.00
	1145 x 545	830	400	400	41.05	£495.00
HAND CARTS WITH 4 SIDES 2 WHEELS, T-BAR HANDLE	795 x 445	680	200	260	41.07	£408.00
	845 x 545	830	400	400	41.08	£511.00
	1145 x 545	830	400	400	41.09	£590.00
	945 x 545	600	400	260	41.22	£796.00
HAND CARTS WITH 4 SIDES 4 WHEELS, SAFETY LOOP HANDLE	1145 x 645	700	400	260	41.24	£845.00



## Heavy Duty Hand Trucks

✓ Professional quality trucks which comply with Euro Norm 1757-3

✓ Modular system allows addition of sides and ends as required

- Fully welded steel construction
- Impact resistant powder coat finish in RAL blue 5007
- Tubular corner sleeves retain side and end panels
- Anti-slip waterproof plywood platform
- Crown gear steering
- Safety loop handles with drop safety device
- Cushion rubber or pneumatic tyred wheel options

**5** years  
QUALITY  
GUARANTEE

**700kg**  
To  
**1250kg**  
CAPACITIES



### BRAKING SYSTEM

Automatic braking occurs whenever shaft sinks or rises, with an anti-slip mechanism

**FROM**  
**£763**



Quality powder coat finish on shot blasted steelwork



## Platform Hand Trucks

PLATFORM SIZE L x W (mm)	PLATFORM HEIGHT (mm)	CAPACITY (kg)	RUBBER CUSHIONED TYRES			PNEUMATIC TYRES		
			SIZE	REF	PRICE	SIZE	REF	PRICE
1200 x 800	410	700	250 x 60	1401	£763.00	260 x 85	1402	£780.00
1200 x 800	480	1000	400 x 80	1422	£910.00	400 x 100	1403	£851.00
1600 x 900	480	1000	400 x 80	1404	£1026.00	400 x 100	1405	£967.00
2000 x 1000	480	1250	400 x 80	1406	£1149.00	400 x 100	1407	£1092.00

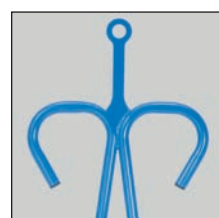

Traction Eye (fitted)

**REF 1441/E**  
**PRICE £34.00**



Coupling (fitted)

**REF 1442/C**  
**PRICE £75.00**



**FROM**  
**£1193**

## 4-Sided Hand Trucks

PLATFORM SIZE L x W (mm)	PLATFORM HEIGHT (mm)	CAPACITY (kg)	RUBBER CUSHIONED TYRES			PNEUMATIC TYRES		
			SIZE	REF	PRICE	SIZE	REF	PRICE
1200 x 800	410	700	250 x 60	1408	£1193.00	260 x 85	1409	£1210.00
1200 x 800	480	1000	400 x 80	1423	£1342.00	400 x 100	1410	£1213.00
1600 x 900	480	1000	400 x 80	1411	£1483.00	400 x 100	1412	£1426.00
2000 x 1000	480	1250	400 x 80	1413	£1672.00	400 x 100	1414	£1613.00



## Folding Trucks

### Budget Fold Flat Truck

✓ Carries 90kg ✓ Weighs just 9.8kg

- Simple push-button handle extension
- Wheels extend automatically when platform is lowered
- Elasticated load retainer straps
- Folds away to 690 x 490 x 60mm
- Footplate 485 x 260mm
- Non-marking 185mm wheels

REF BC2A PRICE £60.00

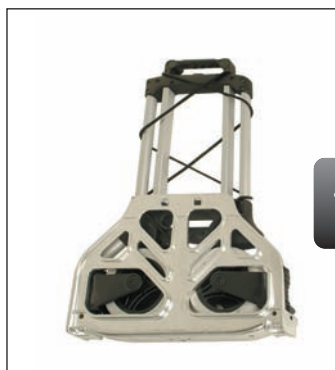

JUST 60mm  
THICK WHEN  
FOLDED



★  
**BUDGET  
CHOICE!**  
★

BC2A  
**£60**

### Premium Fold Flat Trucks

✓ Capacities 50-250kg ✓ So quick and simple to extend

- Premium quality aluminium & steel tube construction
- Non-slip cast aluminium footplate
- Comfortable non-slip hand grips
- Integral elasticated strap for safe load retention
- Non-marking polymer wheels with roller bearings (50/125kg models)
- Pneumatic tyres on roller bearing wheels (250kg model)



1730  
**£85**



1732  
**£118**



1735  
**£268**



*Ready to use within  
a few seconds!*

#### Premium Fold Flat Trucks

CAPACITY (kg)	OVERALL H x W (mm)	FOLDED H x W x D (mm)	FOOTPLATE L x W (mm)	WHEEL DIA (mm)	WEIGHT (kg)	ORDER REF	PRICE
50	1030 x 390	595 x 390 x 50	300 x 385	127	3.2	1730	£85.00
125	1090 x 488	765 x 488 x 64	320 x 480	170	5.2	1732	£118.00
250	1190 x 660	855 x 660 x 135	450 x 595	220	12.6	1735	£268.00

**5** years  
**QUALITY  
GUARANTEE**







CS258  
£66

### Economy Sack Truck

#### ✓ Top value

- Durable powder coat finish
- 100kg capacity • Weight 10kg
- 200mm solid rubber tyres
- 1000H x 470W x 410Dmm
- 410W x 180Dmm footplate

REF CS258 PRICE £66.00



CS662  
£107

### Universal Sack Truck

#### ✓ Welded all steel construction

- Braced frame for extra rigidity
- 100kg capacity • Weight 8kg
- 200mm solid rubber tyres
- 1085H x 505W x 475Dmm
- 350W x 260Dmm footplate

REF CS662 PRICE £107.00

★ BEST ★  
SELLER



CS161  
£80

### Folding Truck

#### ✓ Ideal for deliveries, easily carried in car or van

- Fold away toe for compact storage • 100kg capacity
- Weight 5kg
- 150mm solid rubber tyres
- 1020H x 360W x 170Dmm
- 300W x 380Dmm footplate

REF CS161 PRICE £80.00



AST/2  
£72

### Collapsible Sack Truck

#### ✓ A great space saver

- Fold away toe and telescopic frame • Capacity 90kg
- Weight 7kg • 150mm wheels
- 360W x 240Dmm footplate
- Extended 1090H x 412Wmm
- Folded 715H x 412Wmm

REF AST/2 PRICE £72.00

Super  
lightweight  
aluminium,  
only 7kg!

## Rough Terrain Truck

#### ✓ Load capacity 250kg

- Weight 14kg • PVC strips protect load
- Large 250mm pneumatic wheels give smooth ride over uneven surfaces
- P-handle for sure grip on tall loads
- Overall 1315H x 550W x 495Dmm
- Footplate 550W x 228Dmm

REF CS340 PRICE £99.00



LOAD CAN BE RESTED  
HORIZONTALLY

CS340  
£99



CS360  
£191

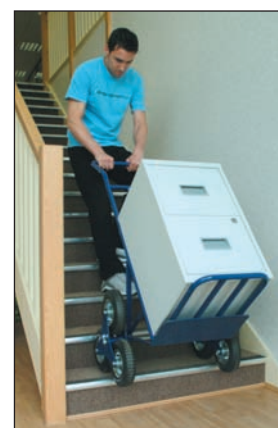

Foldaway toe for  
larger loads

## Wide Base Stairclimber

#### ✓ Safe working load on stairs - 50kg

- Tubular steel construction • Large, deep folding foot
- 120kg maximum load as a sack truck
- 3 star wheel arrangement • Weight 15kg
- 200mm pneumatic tyred wheels
- Overall 1160H x 605W x 795Dmm
- Fixed toe plate 410W x 200Dmm
- Folding toe 395W x 460Dmm

REF CS360 PRICE £191.00



## Folding Trucks

## Folding Toe Trucks



- ✓ Space saving trucks, ideal for boot of car
- ✓ Instantly unfold ready for use
- ✓ Tough powder coat finish
- Lightweight model weighs just 6kg and carries 100kg
- Heavy duty model weighs 15kg and carries 200kg

- ✓ Pneumatic tyred trucks for all terrain use
- ✓ Powder coat finish
- Both models have collapsible lifting blade and one with a second fixed footplate
- Impact and scratch resistant finish
- Trackless tyres with roller bearing hubs

CAPACITY (kg)	FOOTPLATE L x W (mm)	OVERALL H x W (mm)	CUSHION TYRES	WEIGHT (kg)	ORDER REF	PRICE
100	360 x 310	990 x 485	150 x 40	6	BC299	£85.00
200	410 x 355	1140 x 555	200 x 50	15	BC158	£123.00

CAPACITY (kg)	FOOTPLATE L x W (mm)	OVERALL H x W (mm)	PNEUMATIC TYRES	WEIGHT (kg)	ORDER REF	PRICE
250	500 x 330	1150 x 620	260 x 85	14.5	K1115L	£181.00
250	150x500 / 400x330	1150 x 620	260 x 85	14.5	K1116L	£186.00

## Super 3-Way Truck

✓ The only truck many businesses will need! A superb workhorse which carries out most of the day-to-day duties and folds away when not required. Quickly and easily converted between its three modes. Quality powder coat finish.

- As a sack truck: 1420mm high, with 480W x 180Dmm foot iron
- As a 4-wheel sack truck: 1010H x 1440Lmm
- As a platform truck: 830H with 1120L x 465Wmm load area
- Overall width 480mm • Weight 27kg
- Capacity – 300kg as sack truck, 400kg as 4-wheel & platform truck

REF BC350 PRICE £224.00

**RAPID  
DELIVERY**

**2** years  
GUARANTEE

**3 Trucks in 1**

BC350  
£224



IT'S A BASIC SACK TRUCK!

IT'S A PLATFORM TRUCK!

IT'S A STABLE 4-WHEEL TRUCK!



## Economy Sack Truck

✓ Big on performance, low on price

- 305W x 190Dmm foot
- 165 x 50mm rubber plain bore wheels
- 1000H x 450Wmm overall
  - Weight 11.5kg
  - 150kg capacity

REF BC.129

PRICE £79.00

BC.129

£79

Kerb ramps available, see page 322



Quality British trucks, with superior powder coat finish

## Heavy Duty Sack Truck

✓ Heavy duty angle iron frame

✓ Extra large foot

- Capacity 300kg
- 380W x 320Dmm foot
- 1140H x 550Wmm overall
- 200 x 50mm rubber tyres
- Weight 20kg

REF BC157

PRICE £119.00

★ BEST ★  
SELLER

BC157

£119

**RAPID  
DELIVERY**

**2** years  
GUARANTEE

BC149

£99

BC149HET

£110

BC149X

£129

BC139

£108

IDEAL FOR  
NARROW  
DOORWAYS

## 200kg Warehouse Trucks

✓ Centre strap design suits all types of load

### Standard Truck

- 420W x 200Dmm foot
- 200 x 50mm rubber roller bearing wheels
- 1120H x 530Wmm overall
  - Weight 15kg

REF BC149 PRICE £99.00

### Extended Footplate

- 420W x 280Dmm foot
- 200 x 50mm rubber roller bearing wheels
- 1120H x 530Wmm overall
  - Weight 15kg

REF BC149HET PRICE £110.00

### Pneumatic Tyres

- 420W x 200Dmm foot
- 260 x 85mm 4-ply pneumatic roller bearing wheels
- 1120H x 530Wmm overall
  - Weight 16kg

REF BC149X PRICE £129.00

### Narrow Truck

- 420W x 200Dmm foot
- 200 x 50mm rubber roller bearing wheels
- 1120H x 420Wmm overall
  - Weight 15kg

REF BC139 PRICE £108.00



## Sack Trucks

MATERIALS HANDLING

### Stacker Truck

- ✓ For high stacked carton loads
- ✓ 350kg capacity



**5** years  
QUALITY  
GUARANTEE

- All welded tubular steel frame
- Powder coated in RAL blue 5007
- Impact and scratch resistant
- Cushion rubber or pneumatic tyred wheels
- Hubs with roller bearings
- Fixed lifting blade 250L x 300Wmm
- Overall height 1600mm, width 570mm

Cushion Rubber Tyres, 250 x 60mm  
Weight 18kg

REF G102 PRICE £254.00

Pneumatic Tyres, 260 x 85mm  
Weight 16kg

REF G102L PRICE £254.00

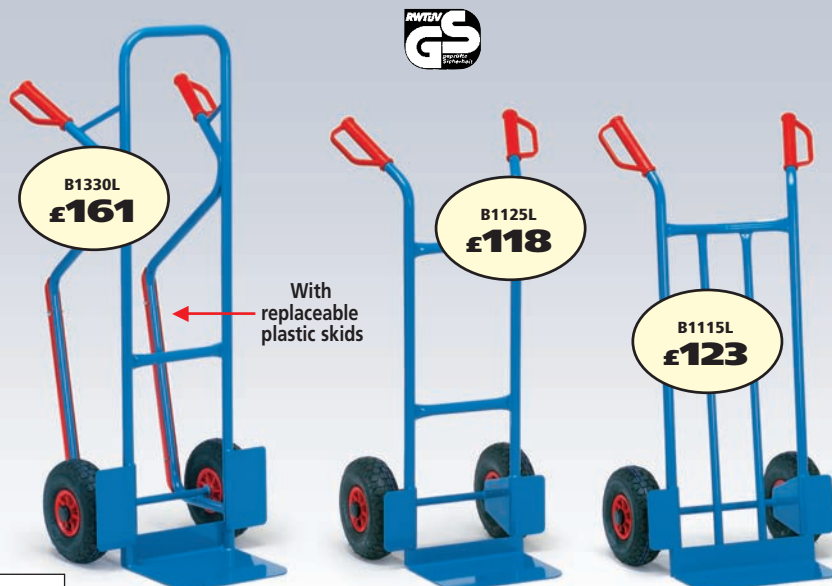

### Ecoline Steel Sack Trucks

- Capacities to 300kg
- Cushion rubber or pneumatic tyred wheel options
- Roller bearing hubs
- Scratch resistant epoxy powder coating in RAL blue 5007

FOOTPLATE SIZE L x W (mm)	OVERALL SIZE H x W (mm)	CAPACITY (kg)	CUSHION RUBBER TYRES			PNEUMATIC TYRES		
			SIZE	REF	PRICE	SIZE	REF	PRICE
150 x 400	1150 x 620	250	250 x 60	B1115	£123.00	260 x 85	B1115L	£123.00
250 x 320	1150 x 570	200	250 x 60	B1125	£118.00	260 x 85	B1125L	£118.00
250 x 320	1300 x 580	300	250 x 60	B1330	£161.00	260 x 85	B1330L	£161.00

**RAPID  
DELIVERY**

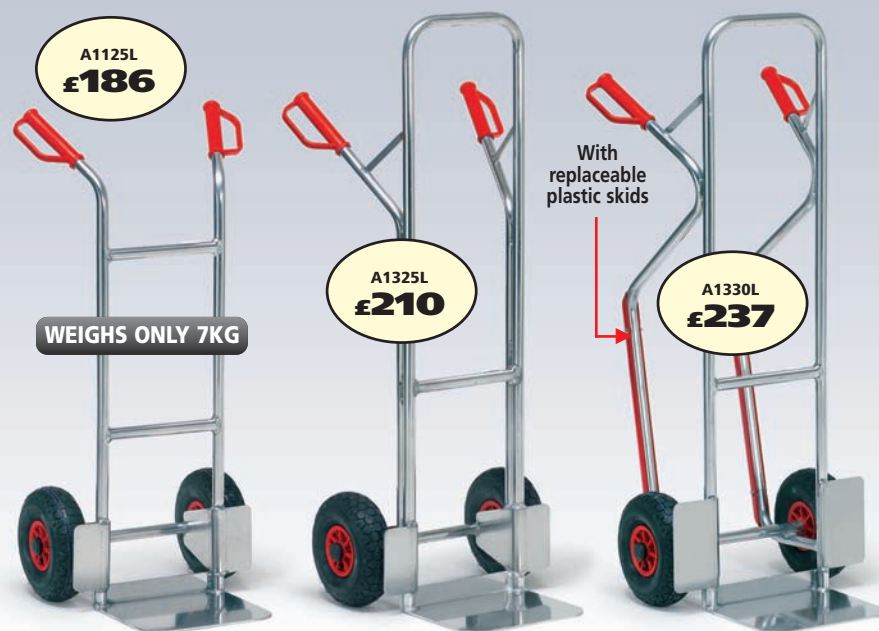

WEIGHS ONLY 7KG

### Lightweight Aluminium Sack Trucks

- Constructed from prime tubular aluminium
- Very light and easy to use
- Pneumatic tyred wheels with roller bearing hubs
- Capacities to 200kg

CAPACITY (kg)	HEIGHT (mm)	FOOTPLATE LENGTH (mm)	FOOTPLATE WIDTH (mm)	OVERALL WIDTH (mm)	PNEUMATIC TYRES	WEIGHT (kg)	ORDER REF	PRICE
150	1150	250	230	570	260 x 85	7	A1125L	£186.00
200	1300	250	320	570	260 x 85	8	A1325L	£210.00
200	1300	250	320	570	260 x 85	9	A1330L	£237.00



## Appliance Trucks

- ✓ Rugged trucks for heavy or bulky loads
- ✓ Stairclimbers and carrier spar options
- Widely spaced handles for best control
- Rubber padded frame will not scratch load
- 450 x 150mm footplate with non-slip cover



Carrier Spar (for two-man use on stairs)  
REF 1053 PRICE £42.00



GK2  
£254

**5** years  
QUALITY  
GUARANTEE



350kg capacity  
Overall 1150H x 650Wmm  
260 x 85mm pneumatic tyres  
REF GK2 PRICE £254.00



11042  
£281

350kg capacity  
Overall 1425H x 650Wmm  
260 x 85mm pneumatic tyres  
REF 11042 PRICE £281.00



BC142  
£151

**2** years  
GUARANTEE

## Economy Chair Carrier

- ✓ Simple low-cost design
  - ✓ Suits chairs with protruding rear feet
  - Capacity 200kg • Weight 12kg
  - 560W x 150Dmm foot well
  - 200 x 50mm cushion rubber roller bearing wheels
  - 1150H x 560Wmm overall
- REF BC142 PRICE £151.00

## Heavy Duty Chair Carrier

- ✓ Suits most types of stacking chairs
  - ✓ Robustly made for 300kg carrying capacity
  - Infinitely variable lifting arm height
  - Powder coated tubular steel • Weight 16kg
  - 260 x 85mm all terrain pneumatic tyres on roller bearings
  - 1300H x 580Wmm, arms 250L x 320Wmm
- REF B1335L PRICE £191.00



When not in use  
as a chair carrier,  
the arms fold  
down to allow use  
for other purposes



B1335L  
£191

**RAPID**  
DELIVERY

**5** years  
QUALITY  
GUARANTEE



## Stairclimber Trucks

**RAPID  
DELIVERY**
**2** years  
GUARANTEE

BC152

**£179**

### Heavy Duty Stairclimber

✓ For safe handling of goods up and down stairs or kerbs

- 300kg capacity • Weight 21kg
- Twin star-wheel assemblies "walk" from step to step
- 475W x 170Dmm foot • 160 x 45mm star-wheels
- Overall 1425H x 480W x 530Dmm

**REF BC152 PRICE £179.00**

### Folding Toe Stairclimber

✓ The all purpose on-van delivery truck

- Star wheels 'walk' from step to step
- Folds compactly for transit
- Capacity 180kg • Weight 19kg
- 150 x 40mm rubber plain bearing wheels
- Footplate 350W x 410Lmm
- Overall 1143H x 555Wmm

**REF BC386 PRICE £199.00**

BC386

**£199**
**2** years  
GUARANTEE

TK1325

**£240**

AK1325

**£325**
**5** years  
QUALITY  
GUARANTEE

TK1327

**£339**

### Steel Stairclimber

✓ An ideal general purpose stairway truck

- 200kg capacity • Safety handles
- Sturdy welded construction
- 2 three-armed wheel spiders, each equipped with three 160x40mm solid rubber tyres
- Footplate 320W x 250Lmm
- Overall 1300H x 590Wmm

**REF TK1325 PRICE £240.00**

### Aluminium Stairclimber

✓ Lightweight, strong and very easy to handle

- 200kg capacity • Safety handles
- Braced aluminium frame
- 2 three-armed wheel spiders, each equipped with three 160x40mm solid rubber tyres
- Footplate 320W x 250Lmm
- Overall 1300H x 590Wmm

**REF AK1325 PRICE £325.00**

### Combi Stairclimber & Sack Truck

✓ 2-in-1 design

✓ Large wheels allow use as regular sack truck

- 200kg capacity • Safety handles
- Pneumatic tyres 260 x 85mm, roller bearings
- 2 five-armed wheel spiders, each equipped with 5 solid rubber tyres 125mm dia.
- Footplate 320W x 250Lmm
- Overall 1300H x 590Wmm

**REF TK1327 PRICE £339.00**





★ NEW ★  
PRODUCTS

## Powered Stairclimbers & Mobile Tail Lift

✓ PowerMate moves heavy and awkward loads on and off vehicles and up and down steps and stairs with maximum speed, safety and professionalism

### Models M, LE, L, Pogo

- ✓ Capacities up to 680kg
- ✓ 7 flights of 12 tread stairs per battery
- ✓ Safety braking system as standard
- ✓ Certificated training included
- Operates on tight landings
- Delivers to installation point
- Minimises physical effort & premises damage
- Eliminates product and premises damage
- One-man operation reduced manpower
  - In transit charging kit



A full range of accessories is available for our stairclimbers. Call us now!



SPECIFICATIONS	POGOP-2	MODEL L-1	MODEL M-1	MODEL M-2B	MODEL LE-1
MAXIMUM CAPACITY (kg)	100	295	680	680	318
MAXIMUM HEIGHT DECK/DOCK (mm)	1220	840	840	840	-
MAXIMUM ELEVATION (mm)	790	-	-	-	1010/840
OVERALL W x D x H (mm)	550 x 560 x 1220	610 x 420 x 1520	685 x 430 x 1520	685 x 430 x 1730	610 x 540 x 1520
WEIGHT (kg)	31	45	75	82	92
TOE PLATE (mm)	375 x 175	610 x 100	610 x 150	685 x 150	610 x 150
WHEELS 200MM DIA RUBBER	PNEUMATIC	SOLID	SOLID	SOLID	SOLID
FELTED STRAP BAR INCL 3M STRAP	1 (2mm)	1	2	2	2
LOAD HOLD CLUTCH	✓	✓	✓	✓	✓
ONE WAY WHEEL BRAKES	SWING WHEEL BRAKES	OPTIONAL EXTRA	OPTIONAL EXTRA	OPTIONAL EXTRA	✓
FOLD DOWN DOLLY	-	-	✓	✓	-
GEL FILLED LEAK PROOF BATTERY	12V - 20AMP	12V - 20AMP	12V - 30AMP	12V - 30AMP	12V - 30AMP
ELECTRONIC CHARGER	SINGLE PHASE	220/240V - 4AMP	220/240V - 4AMP	220/240V - 4AMP	220/240V - 7AMP
TRUCK CONSTRUCTION	ALUMINIUM/STEEL	ALUMINIUM	STEEL	STEEL	ALUMINIUM
ORDER REF	POGOP-2	L-1	M-1	M-2B	L-E1
PRICE	£2152.00	£2689.00	£2896.00	£3216.00	£3856.00